

INVENTORY SITE PLAN
ZIMMER CANCER CENTER RENOVATION
2131 SOUTH 17TH STREET
WILMINGTON, N. C.

OWNER/DEVELOPER
 NHRMC
 THOMAS WALSH, VP FACILITIES
 AND SUPPORT SERVICES
 PO BOX 9000
 WILMINGTON, NC 28402
 910-343-2788

NORRIS & TUNSTALL
CONSULTING ENGINEERS, P.C.
 902 MARKET STREET
 WILMINGTON, NC 28401
 PHONE (910) 343-6653
 license #C-3641

CONSTRUCTION DOCUMENTS
15120
 DES. JUST
 CKD. JPN
 DRWN. NKS
 DATE 4/15/16

SCALE: 1" = 20'

11

NOW OR FORMERLY
 G M REALTY PTNRP LLC
 BOOK 4950 PAGE 1720
 ZONED O&I
 MEDICAL OFFICE

NOTE:
 ORIGINAL SURVEY BY BOB JONES COMPLETED IN 2013.
 TREES WITHIN PROJECT AREA HAVE BEEN FIELD MEASURED
 BY N&T ENGINEERS AND THE SURVEY HAS BEEN UPDATED,
 WITH THE CONSENT OF THE SURVEYOR, TO REFLECT THE
 CHANGES.

INVENTORY SITE DATA

PARCEL ADDRESS:	2131 S. 17TH STREET
PARCEL ID#:	R06011-004-001-000
MAP ID#:	312607.57.9873.000
ZONING:	O&I-1 OFFICE AND INSTITUTIONAL
SOIL TYPES:	Ur
CAMA LAND USE:	URBAN
SITE DOES NOT LIE WITHIN 100 YEAR FLOOD PLAIN	
NO CAMA AEC OR SETBACKS	
HISTORICAL SITE:	NONE
CEMETERY:	NONE
FORESTED AREA:	SEE PLAN FOR TREE SURVEY
WETLANDS:	NONE EXIST WITHIN SITE AREA
ENDANGERED SPECIES/HABITAT:	NONE REPORTED

For each open utility cut of
 City streets, a \$325 permit
 shall be required from the
 City prior to occupancy
 and/or project acceptance.

CITY OF WILMINGTON
 NORTH CAROLINA
 Public Services • Engineering Division
 Stormwater Management Plan

Date: 4/29/16 Permit #: 2016016

Approved Construction Plan

Name: [Signature] Date: 4/28/16
 Planning: [Signature] 4/28/16
 Traffic: [Signature] 4/28/16
 Fire: [Signature] 5/4/16

NC DENR PWSS WATER PERMIT #:	
WATER CAPACITY:	_____ GPD
DWQ SEWER PERMIT #:	
SEWER CAPACITY:	_____ GPD
SEWER SHED # AND PLANT:	
SEWER TO FLOW THROUGH NEI:	YES OR NO (CIRCLE ONE)

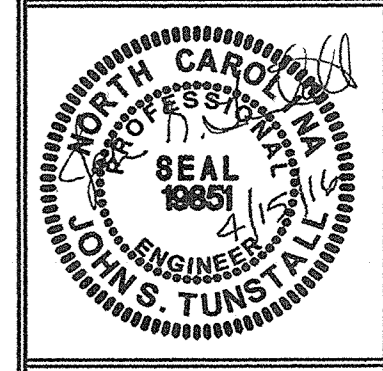

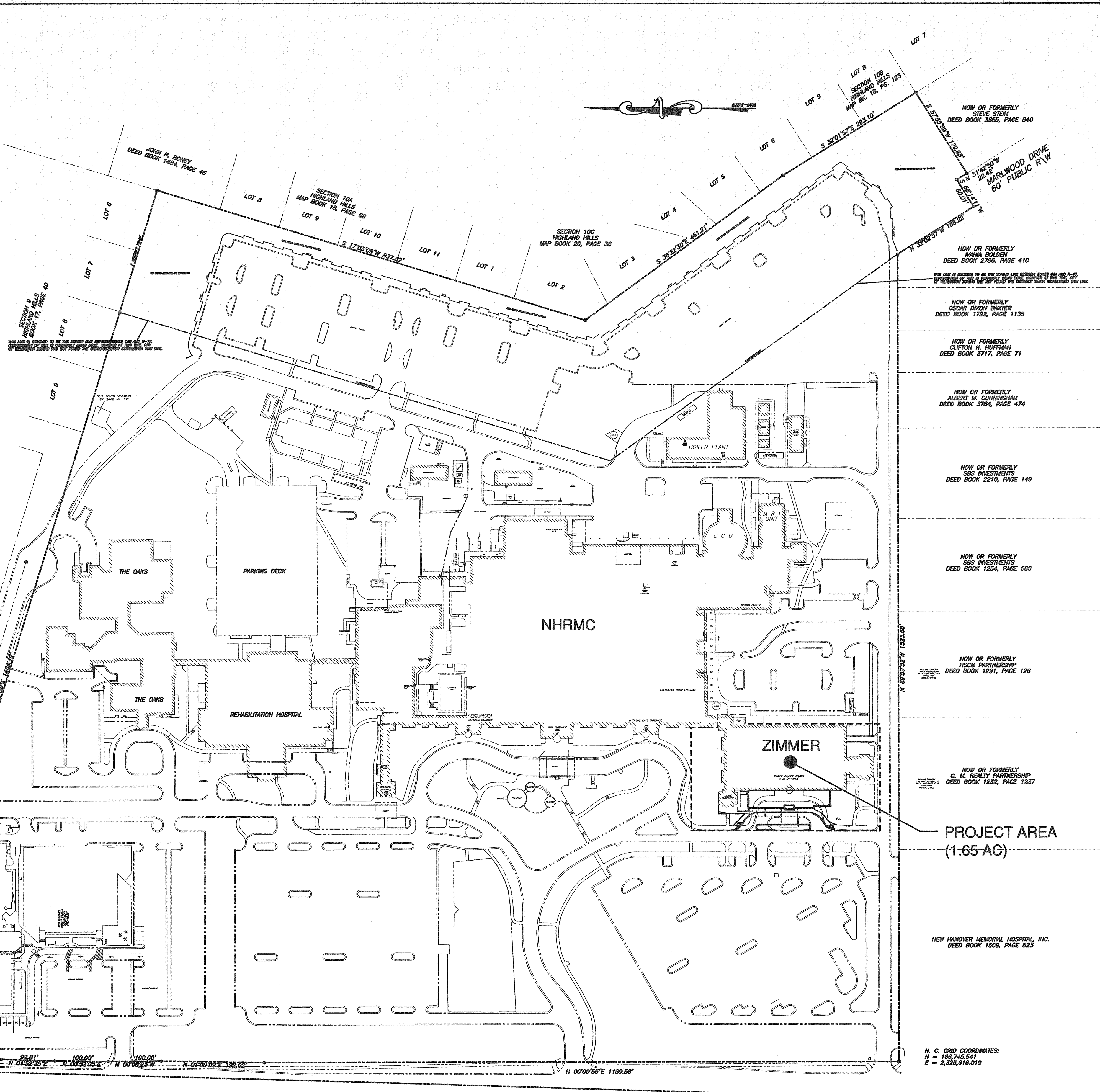
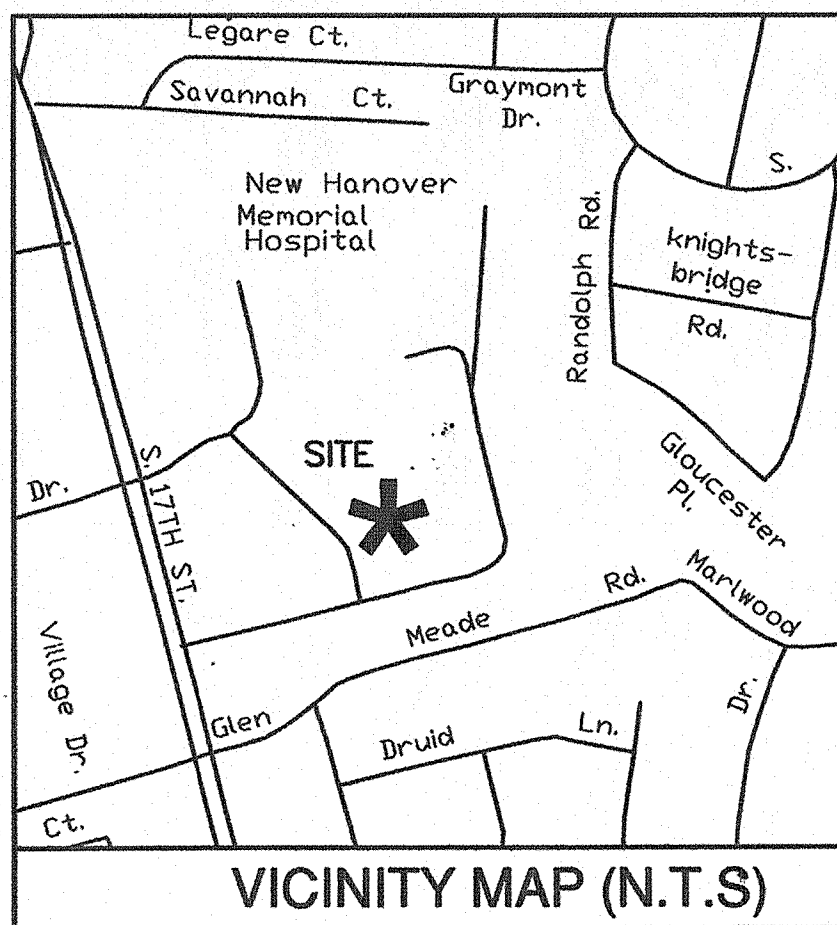

ZIMMER SITE DATA TABLE

USE: HOSPITAL CANCER TREATMENT (NHRMC)
 SITE ADDRESS: 2131 S. 17TH STREET
 PARCEL ID#: R08011-004-001-000
 MAP ID#: 312607.57,9873.000
 PARCEL AREA: 50.38 AC
 PROJECT AREA: 1.65 AC (72,075 SF)
 ZONING: O&I-1 OFFICE AND INSTITUTIONAL
 CANA LAND USE: URBAN
 BUILDING SETBACKS (REQUIRED): FRONT SETBACK: 20'
 INTERIOR SIDE SETBACK: 10'
 CORNER SIDE SETBACK: 20'
 REAR SETBACKS: 20'

BUILDING SETBACKS:
 INTERIOR SIDE SETBACK: EXIST. BLDG: 98'±
 INTERIOR SIDE SETBACK PROPOSED EXP: 128'±
 FRONT SETBACK: EXIST. BLDG: 512'±
 FRONT SETBACK PROPOSED EXP: 475'±

FLOOR	EXISTING (SQ FT)	NEW (SQ FT)	SUB-TOTAL
3rd Floor/2ndhouse	13,300		13,300
2nd Floor	29,010		29,010
1st Floor	29,010	5,167	34,177
Service	29,010	5,250	34,260
TOTAL occupied area 75,030			
TOTAL IMPERVIOUS AREA 85,490			

BUILDING EXPANSION AREA: 5,167 SF (FOOT PRINT)
 PERCENT EXPANSION AREA: 16.92%
 EXISTING BUILDING HEIGHT: VARIES 33'-65' (SEE ARCH. PLANS)
 BUILDING EXPANSION HEIGHT: 33'± (SEE ARCH. PLANS)
 BUILDING CANOPY HEIGHT: 13'-4' CLEAR
 EXISTING BUILDING STORES: 3 (PLUS MECHANICAL)
 BUILDING EXPANSION STORES: 2
 BUILDING CONSTRUCTION TYPE: II-B

PARKING REQUIREMENT HOSPITAL:
 1 PER EACH 2 LICENSED BEDS INTENDED FOR PATIENT USE, 1 PER EACH STAFF PERSON, INCLUDING MEDICAL AND SUPPORT STAFF BASED ON THE LARGEST EMPLOYEE SHIFT.
 -NO NEW EMPLOYEES WITH BUILDING ADDITION
 -EXISTING PARKING REMAINS

IMPERVIOUS AREA:
 PROJECT AREA: 72,075 SF (1.65 AC)
 EXISTING IMPERVIOUS AREA:
 BUILDING (FOOTPRINT): 32,632 SF
 ASPHALT/CURB AND GUTTER: 7,140 SF
 SIDEWALK/CONCRETE: 6,895 SF
 TOTAL: 46,667 SF
 % PROJECT IMPERVIOUS AREA: 64.47%
 EXISTING IMPERVIOUS AREA REMOVED:
 ASPHALT/CURB & GUTTER: 5,691 SF
 SIDEWALK/CONCRETE: 3,452 SF
 TOTAL: 9,143 SF
 NEW IMPERVIOUS AREA ADDED:
 BUILDING (FOOTPRINT): 5,250 SF
 ASPHALT/CURB & GUTTER: 4,242 SF
 SIDEWALK/CONCRETE: 1,757 SF
 TOTAL ADDED: 11,249 SF
 PROPOSED IMPERVIOUS AREA:
 EXISTING BUILDING: 32,632 SF
 BUILDING ADDITION: 5,250 SF
 ASPHALT/CURB & GUTTER: 5,891 SF
 SIDEWALK/CONCRETE: 5,000 SF
 TOTAL: 48,773 SF
 % PROJECT IMPERVIOUS AREA: 67.39%
 LANDSCAPING REQUIRED:
 10-25% EXPANSION AREA - 4% INTERIOR LANDSCAPING REQUIRED
 15 TREES PER ACRE DISTURBED
 DISTURBED AREA=0.57 AC = 8 TREES
 SOLID WASTE DISPOSAL IS HANDLED BY ON SITE DUMPSTERS.
 WATER AND SEWER ARE PRIVATELY OWNED
 WATER AND SEWER DEMANDS REMAIN UNCHANGED

TREE REMOVAL TABLE

REGULATED TREES REMOVED:	NO SIGNIFICANT TREES REMOVED
(1) 11" OAK	
(1) 8" RIVER BIRCH	
(1) 16" FIR (PREVIOUSLY REPORTED)	
(1) 12" FIR (PREVIOUSLY REPORTED)	

For each open utility cut of City streets, a \$325 permit shall be required from the City prior to occupancy and/or project acceptance.

CITY OF WILMINGTON
 NORTH CAROLINA
 Public Services • Engineering Division
 STORMWATER MANAGEMENT PLAN
 Date: 4/28/16, Permit # 2016016
 Signed: *[Signature]*

Approved Construction Plan

Name	Date
Planning: <i>[Signature]</i>	4/28/16
Traffic: <i>[Signature]</i>	9-28-16
Fire: <i>[Signature]</i>	5-4-16

NCDENR PWSS WATER PERMIT #:

WATER CAPACITY: _____ GPD

DWQ SEWER PERMIT #:

SEWER CAPACITY: _____ GPD

SEWER SHED # AND PLANT:

SEWER TO FLOW THROUGH NEI: YES or NO (CIRCLE ONE)

N. C. GRID COORDINATES:
 N = 168,573.033
 E = 2,325,144.376

SOUTH 17th STREET PUBLIC ROW VARIES

N. C. GRID COORDINATES:
 N = 168,745.541
 E = 2,325,616.018

N 01°46'23"E 4784.65'HOSPITAL BEARINGS - GROUND DISTANCE
 N 13°09'18"W 4784.65'H. C. GRID BEARINGS - GROUND DISTANCE

N. C. GRID MONUMENT "HARBOR SQUARE"
 N = 164,317.2895
 E = 2,326,112.615

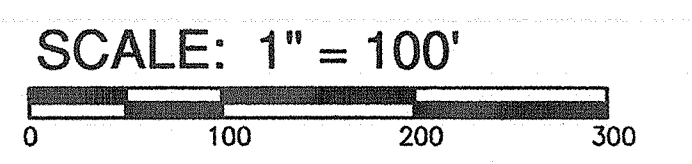

SYMBOL	DATE	DESCRIPTION	BY
		REVISIONS	

OVERALL SITE PLAN
ZIMMER CANCER CENTER RENOVATION
 2131 SOUTH 17TH STREET
 WILMINGTON, N. C.

OWNER/DEVELOPER
 NHRMC
 THOMAS WALSH, VP FACILITIES
 AND SUPPORT SERVICES
 PO BOX 9000
 WILMINGTON, NC 28402
 910.343.2788

NORRIS & TUNSTALL
CONSULTING ENGINEERS, P.C.
 902 MARKET STREET
 WILMINGTON, NC 28401
 PHONE (910) 343-9653
 1429 ASH-LITTLE RIVER RD. NW
 ASH, NC 28420
 PHONE (910) 287-5900
 license #C-3641

CONSTRUCTION DOCUMENTS

15120

DES. JUST
 C.D. JPN
 DRAW. NKS

DATE 4/15/16

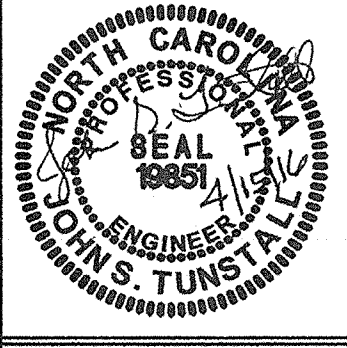

C1

F:\Projects\2015\15120 Zimmer Oncology Renovation\15120 Plans\dwg\15120.master.dwg, 4/14/2016 3:28:52 PM

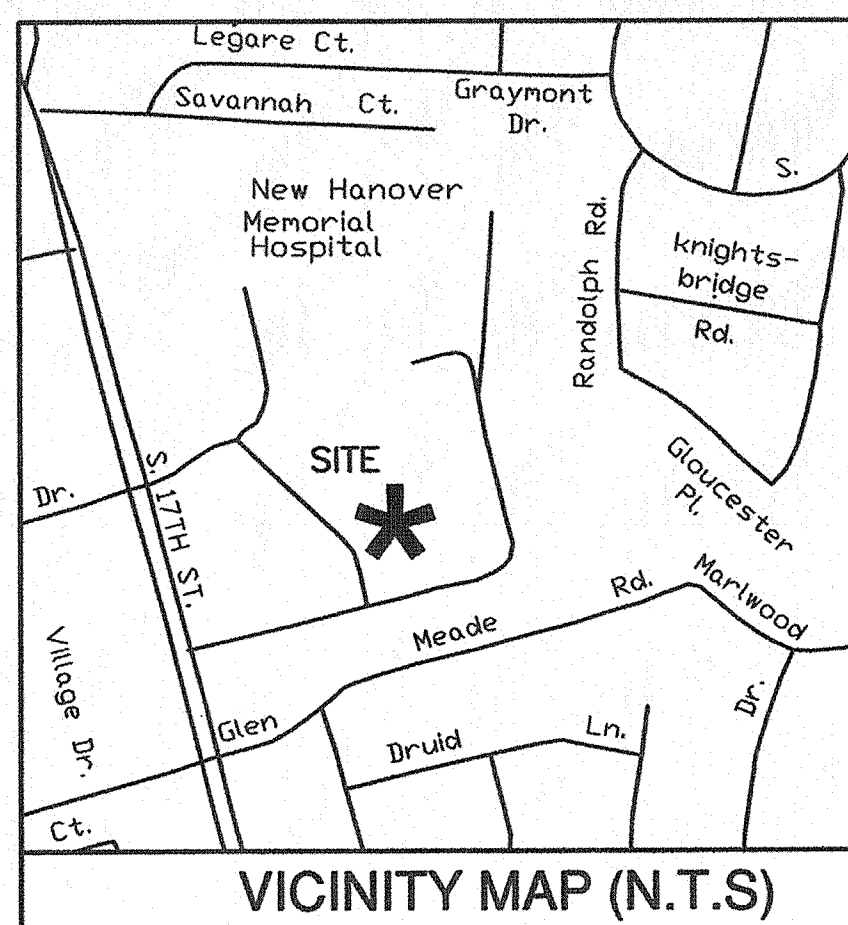
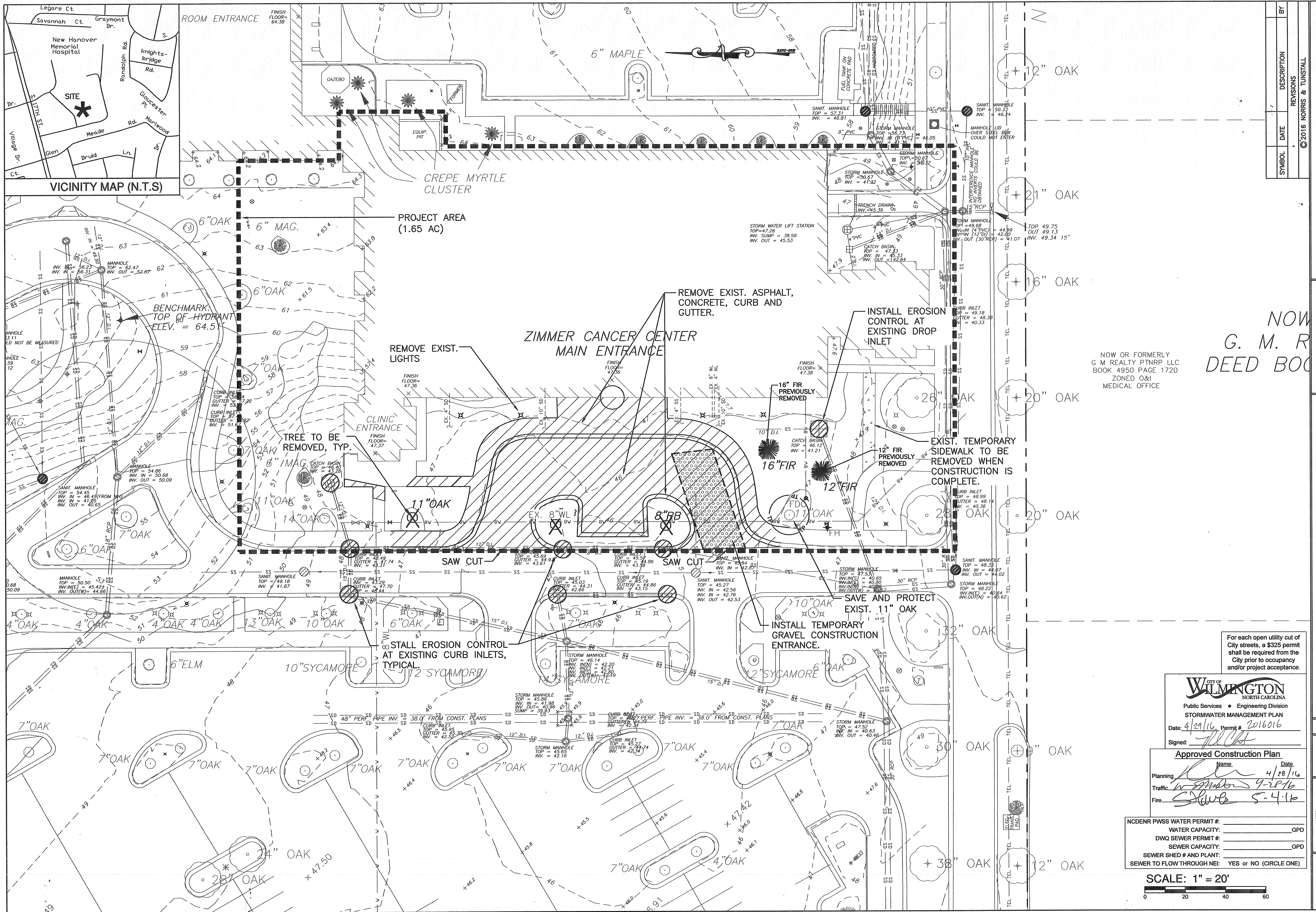

SYMBOL	DATE	DESCRIPTION	BY

DEMOLITION PLAN
ZIMMER CANCER CENTER RENOVATION
 2131 SOUTH 17TH STREET
 WILMINGTON, N. C.

OWNER/DEVELOPER
 THOMAS WALSH, VP FACILITIES
 AND SUPPORT SERVICES
 PO BOX 9000
 WILMINGTON, NC 28402
 910 343-2788

NOW OR FORMERLY
 G. M. R
 DEED BOOK

NOW OR FORMERLY
 G M REALTY PTNRP LLC
 BOOK 4950 PAGE 1720
 ZONED O&I
 MEDICAL OFFICE

NORRIS & TUNSTALL
CONSULTING ENGINEERS, P.C.
 902 MARKET STREET
 WILMINGTON, NC 28401
 PHONE (910) 343-8653
 license #C-3641

CONSTRUCTION DOCUMENTS
 15120
 DES. JUST
 CDR. JPN
 DRWN. NKS
 DATE 4/15/16

For each open utility cut of City streets, a \$325 permit shall be required from the City prior to occupancy and/or project acceptance.

CITY OF WILMINGTON
 NORTH CAROLINA
 Public Services • Engineering Division
STORMWATER MANAGEMENT PLAN
 Date: 4/29/16 Permit # 2016016
 Signed: [Signature]
Approved Construction Plan
 Name: [Signature] Date: 4/28/16
 Planning: [Signature] 4/28/16
 Traffic: [Signature] 4-28-16
 Fire: [Signature] 5-4-16

NCDENR PWSS WATER PERMIT #: _____
 WATER CAPACITY: _____ GPD
 DWQ SEWER PERMIT #: _____
 SEWER CAPACITY: _____ GPD
 SEWER SHED # AND PLAN: _____
 SEWER TO FLOW THROUGH NEI: YES or NO (CIRCLE ONE)

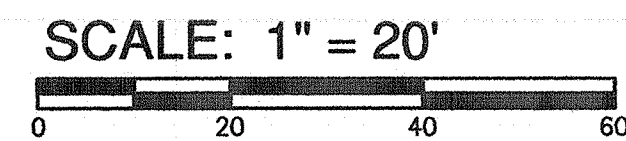

C2

F:\Projects\2015\15120 Zimmer Oncology Renovation\15120-master.dwg, 4/14/2016 3:29:25 PM

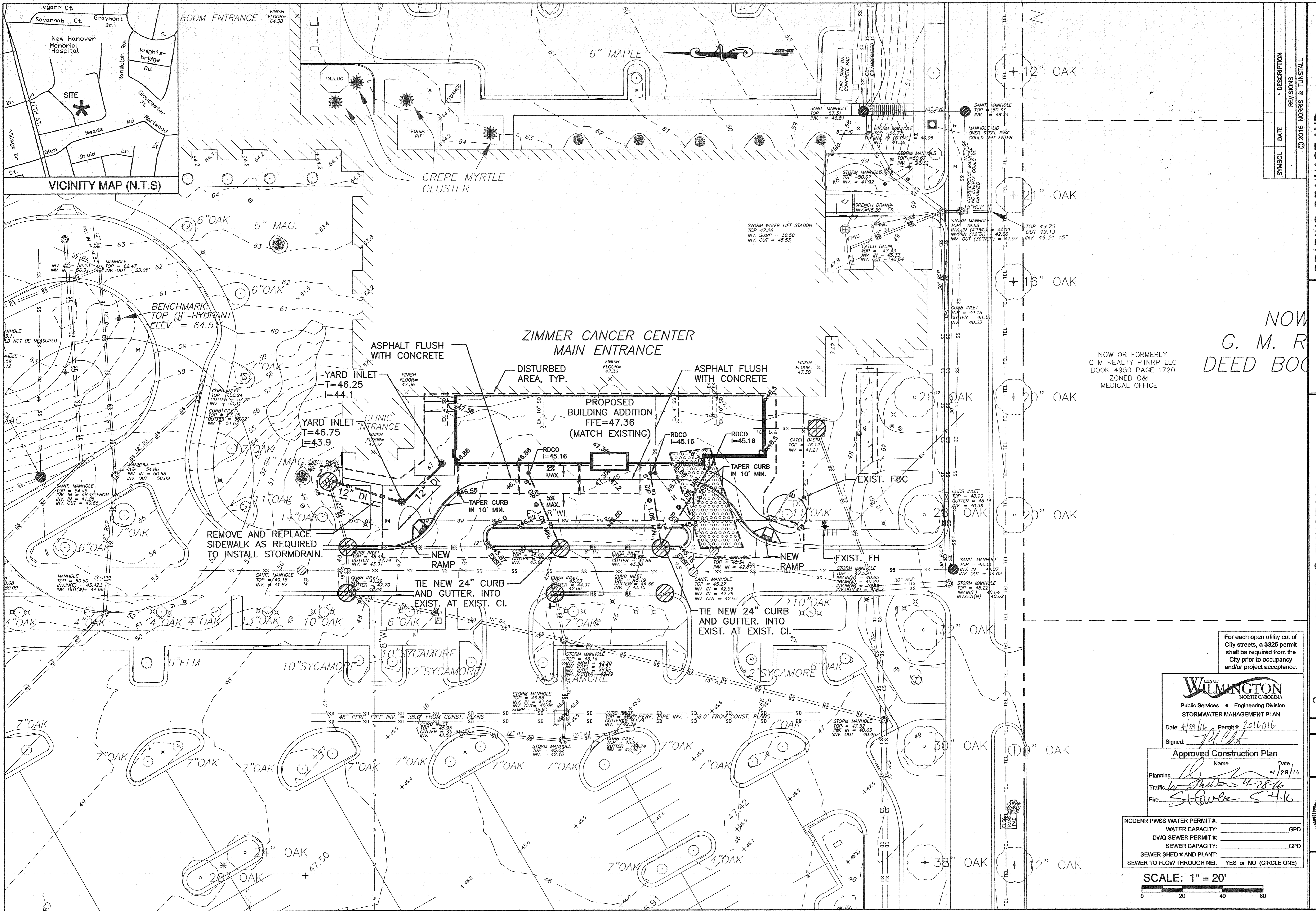

SYMBOL	DATE	DESCRIPTION
		REVISIONS

©2016 NORRIS & TUNSTALL
GRADING, DRAINAGE AND EROSION CONTROL PLAN
ZIMMER CANCER CENTER RENOVATION
 2131 SOUTH 17TH STREET
 WILMINGTON, N.C.

OWNER/DEVELOPER
 THOMAS WALSH, VP FACILITIES AND SUPPORT SERVICES
 PO BOX 9000
 WILMINGTON, NC 28402
 910 343-2788

NOW OR FORMERLY G. M. R. DEED BOOK

NORRIS & TUNSTALL CONSULTING ENGINEERS, P.C.
 1429 ASH-LITTLE RIVER RD, NW
 WILMINGTON, NC 28401
 PHONE (910) 343-9653
 license #C-3541

CONSTRUCTION DOCUMENTS
 15120

DES. JST
 CRD. JPN
 DRWN. NKS
 DATE 4/15/16

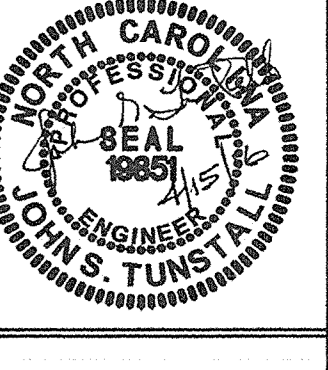

C3

For each open utility cut of City streets, a \$325 permit shall be required from the City prior to occupancy and/or project acceptance.

City of WILMINGTON
 NORTH CAROLINA
 Public Services • Engineering Division
 STORMWATER MANAGEMENT PLAN
 Date: 4/28/16 Permit # 2016016
 Signed: [Signature]

Approved Construction Plan
 Name: [Signature] Date: 4/28/16
 Planning: [Signature] Date: 4/28/16
 Traffic: [Signature] Date: 4/28/16
 Fire: [Signature] Date: 5/4/16

NCDENR PWSS WATER PERMIT #: _____
 WATER CAPACITY: _____ GPD
 DWQ SEWER PERMIT #: _____
 SEWER CAPACITY: _____ GPD
 SEWER SHED # AND PLANT: _____
 SEWER TO FLOW THROUGH NEI: YES OR NO (CIRCLE ONE)

SCALE: 1" = 20'

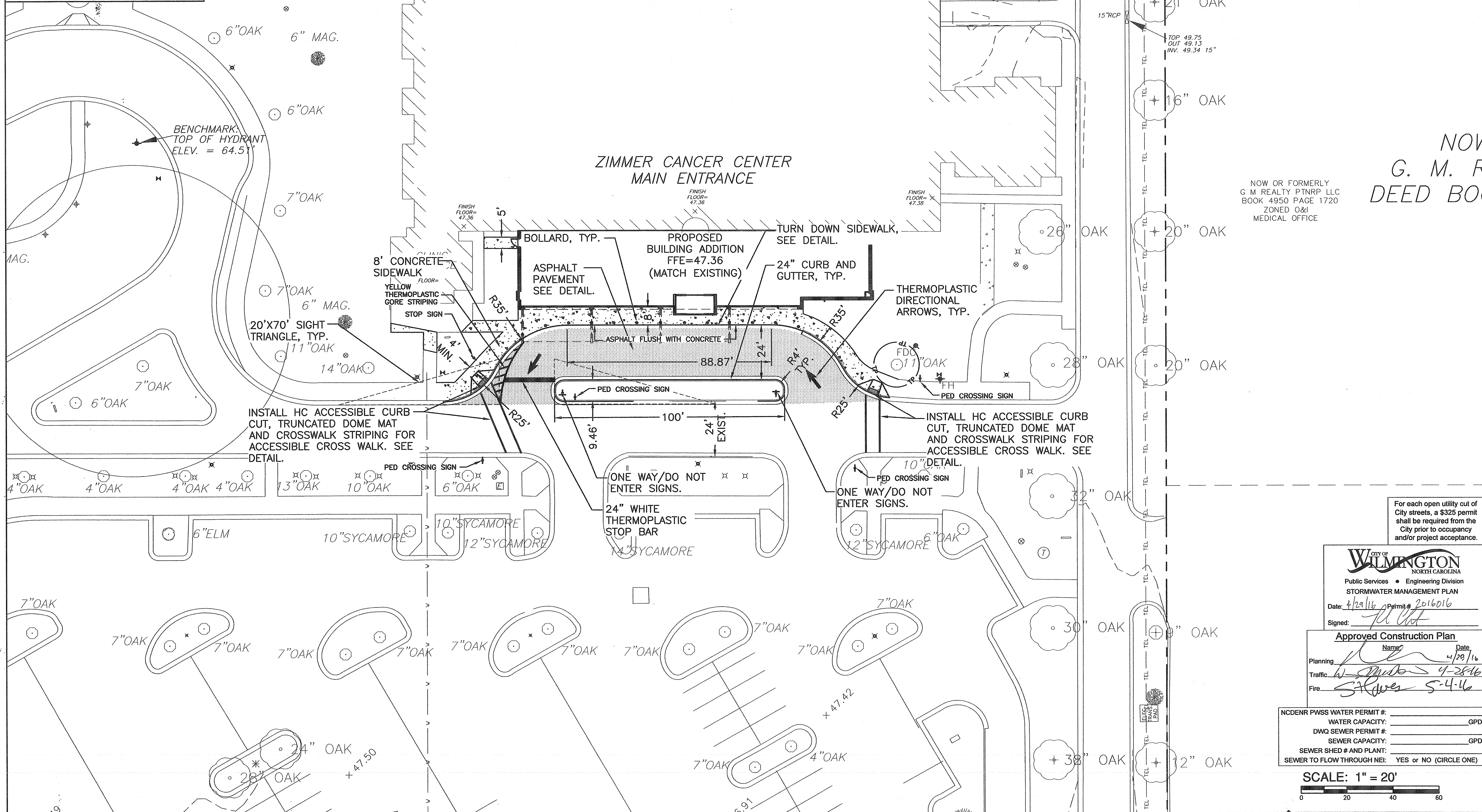
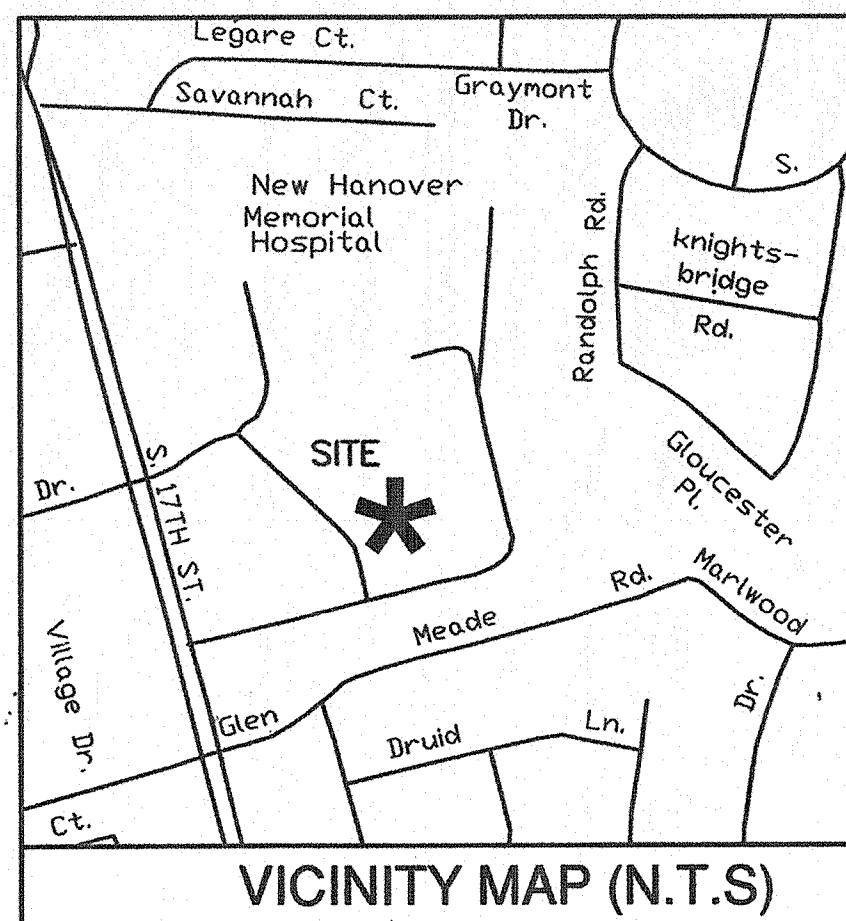

SYMBOL	DATE	DESCRIPTION
		REVISIONS
		© 2016 NORRIS & TUNSTALL

LAYOUT PLAN
 ZIMMER CANCER CENTER RENOVATION
 2131 SOUTH 17TH STREET
 WILMINGTON, N. C.

OWNER/DEVELOPER
 NHRMC
 THOMAS WALSH, VP FACILITIES
 AND SUPPORT SERVICES
 PO BOX 9000
 WILMINGTON, NC 28402
 910 343-2788

NOW
 G. M. R
 DEED BOO

NOW OR FORMERLY
 G M REALTY PTNRP LLC
 BOOK 4950 PAGE 1720
 ZONED O&I
 MEDICAL OFFICE

NORRIS & TUNSTALL
 CONSULTING ENGINEERS, P.C.
 1429 ASH-LITTLE RIVER RD. NW
 WILMINGTON, NC 28401
 PHONE (910) 343-9653
 LICENSE #C-3641

CONSTRUCTION DOCUMENTS
 15120
 DES. JST
 ORD. JPN
 DRWL. NKS
 DATE 4/15/16

For each open utility cut of City streets, a \$325 permit shall be required from the City prior to occupancy and/or project acceptance.

CITY OF WILMINGTON
 NORTH CAROLINA
 Public Services • Engineering Division
 STORMWATER MANAGEMENT PLAN
 Date: 4/29/16 Permit # 2016016
 Signed: [Signature]

Approved Construction Plan
 Name: [Signature] Date: 4/28/16
 Planning: [Signature] 4-28-16
 Traffic: [Signature] 4-28-16
 Fire: [Signature] 5-4-16

NC DENR PWSS WATER PERMIT #:
 WATER CAPACITY: _____ GPD
 DWQ SEWER PERMIT #:
 SEWER CAPACITY: _____ GPD
 SEWER SHED # AND PLANT:
 SEWER TO FLOW THROUGH NEI: YES OR NO (CIRCLE ONE)

SCALE: 1" = 20'
 0 20 40 60

F:\Projects\2015\15120 Zimmer Oncology Renovation\15120 Plans\dwg\15120.master.dwg, 4/14/2016 3:30:35 PM

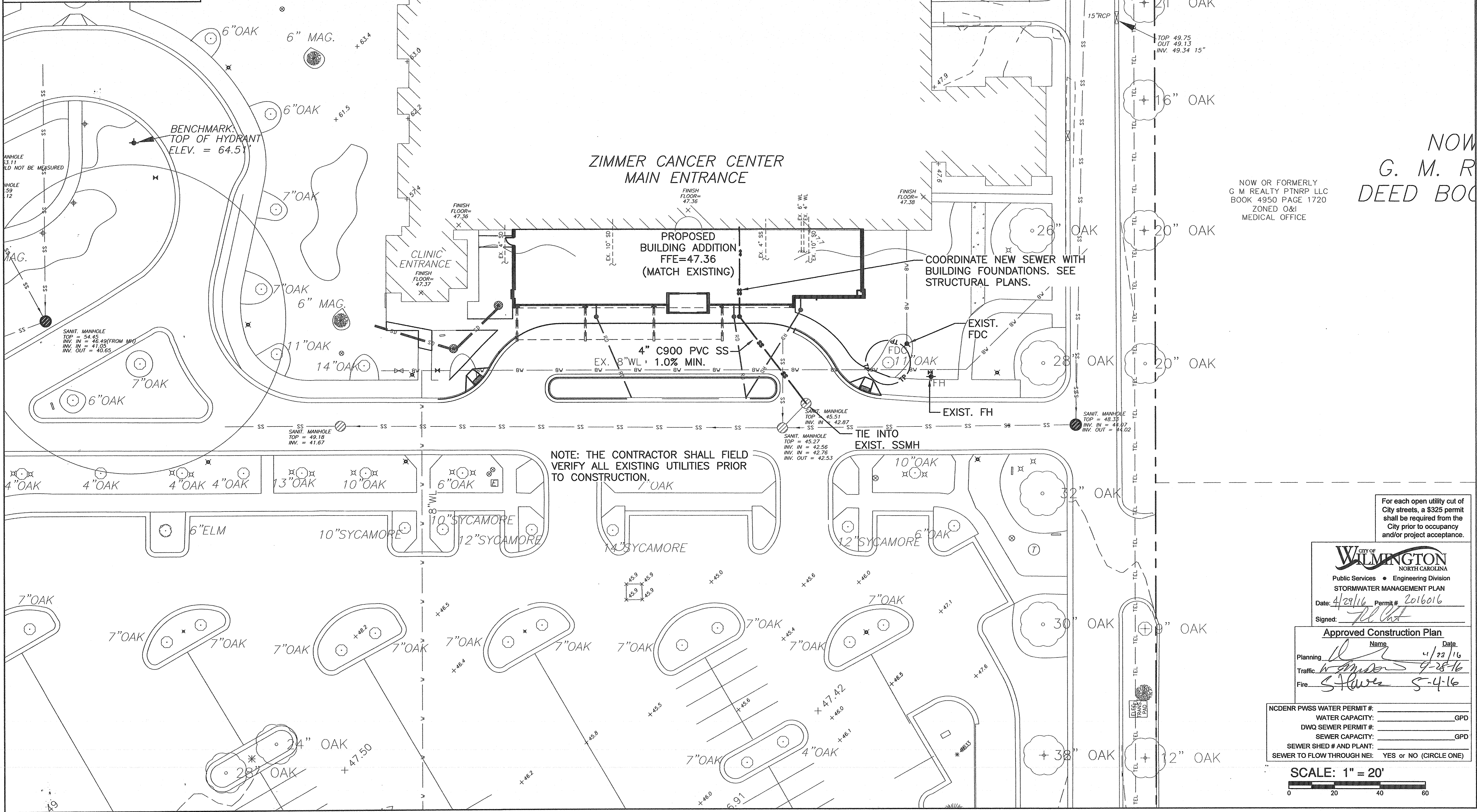
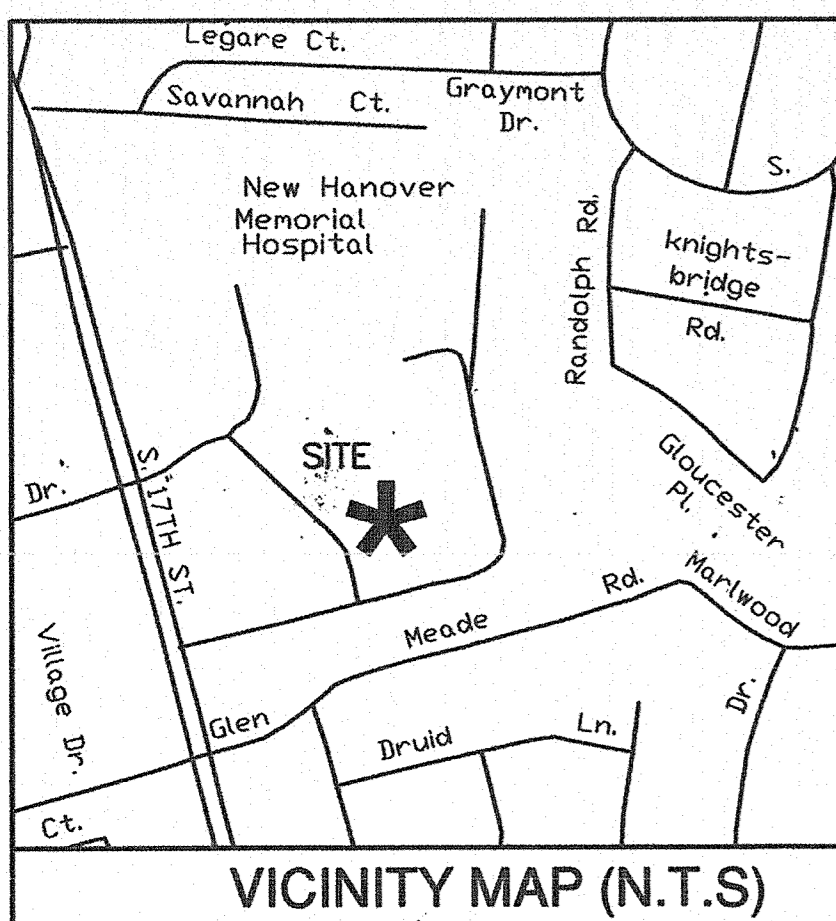

NOTE: THE CONTRACTOR SHALL FIELD VERIFY ALL EXISTING UTILITIES PRIOR TO CONSTRUCTION.

COORDINATE NEW SEWER WITH BUILDING FOUNDATIONS. SEE STRUCTURAL PLANS.

NOW OR FORMERLY
G. M. R.
DEED BOOK

NOW OR FORMERLY
G M REALTY PTNRP LLC
BOOK 4950 PAGE 1720
ZONED O&I
MEDICAL OFFICE

For each open utility cut of City streets, a \$325 permit shall be required from the City prior to occupancy and/or project acceptance.

CITY OF WILMINGTON
NORTH CAROLINA
Public Services • Engineering Division
STORMWATER MANAGEMENT PLAN
Date: 4/29/16 Permit #: 2016016
Signed: *[Signature]*

Approved Construction Plan
Name: *[Signature]* Date: 4/22/16
Planning: *[Signature]* 4/28/16
Traffic: *[Signature]* 4-28-16
Fire: *[Signature]* 5-4-16

NCDENR PWSS WATER PERMIT #:	
WATER CAPACITY:	_____ GPD
DWQ SEWER PERMIT #:	
SEWER CAPACITY:	_____ GPD
SEWER SHED # AND PLAN:	
SEWER TO FLOW THROUGH NEI:	YES or NO (CIRCLE ONE)

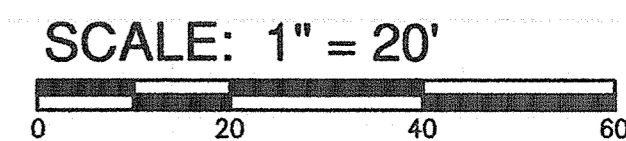

UTILITY PLAN	REVISIONS
ZIMMER CANCER CENTER RENOVATION	BY: _____
2131 SOUTH 17TH STREET	DATE: _____
WILMINGTON, N. C.	DESCRIPTION: _____
OWNER/DEVELOPER	© 2016 NORRIS & TUNSTALL
NORMIC THOMAS WALSH, VP FACILITIES AND SUPPORT SERVICES	
PO BOX 9000	
WILMINGTON, NC 28402	
910 343-2788	
NORRIS & TUNSTALL	
CONSULTING ENGINEERS, P.C.	
1429 ASH-LITTLE RIVER RD. NW	
WILMINGTON, NC 28401	
PHONE (910) 343-9653	
PHONE (910) 287-5900	
license #C-3641	
CONSTRUCTION DOCUMENTS	
15120	
DES. JST	
ORD. JPN	
DRWN. NKS	
DATE 4/15/16	
C5	

BEAVER DAM®

Installation and Maintenance Guidelines

Installation: The empty Beaver Dam® should be placed over the grate as the grate stands on end. If using optional oil absorbents; place absorbent pillow on pouch, on the bottom (down-grade side) of the unit. Attach absorbent pillow to tether loop. Tuck the enclosure flap inside to completely enclose the grate. Holding the lifting devices (do not rely on lifting devices to support the entire weight of the grate), place the grate into its frame (street side first), then lower back edge with dam into place. The Beaver Dam® should be partially blocking the curb when installed properly.

Maintenance: Remove all accumulated sediment and debris from surface and vicinity of unit after each storm event. Remove sediment that has accumulated within the containment area of the Beaver Dam® as needed. If using optional oil absorbents; remove and replace absorbent pillow when near saturation.

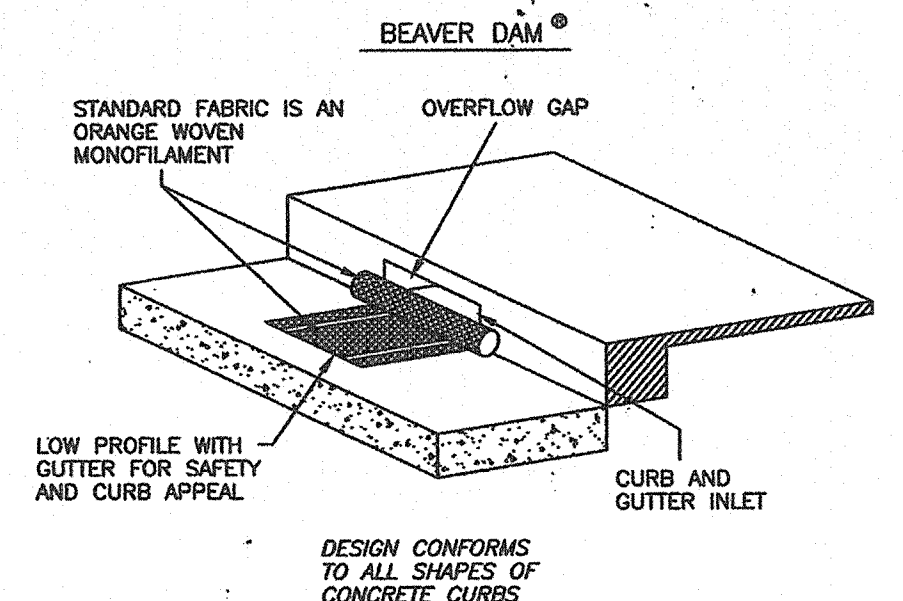

* USE AT EXISTING CURB INLETS IN PAVED AREAS.

NOT TO SCALE

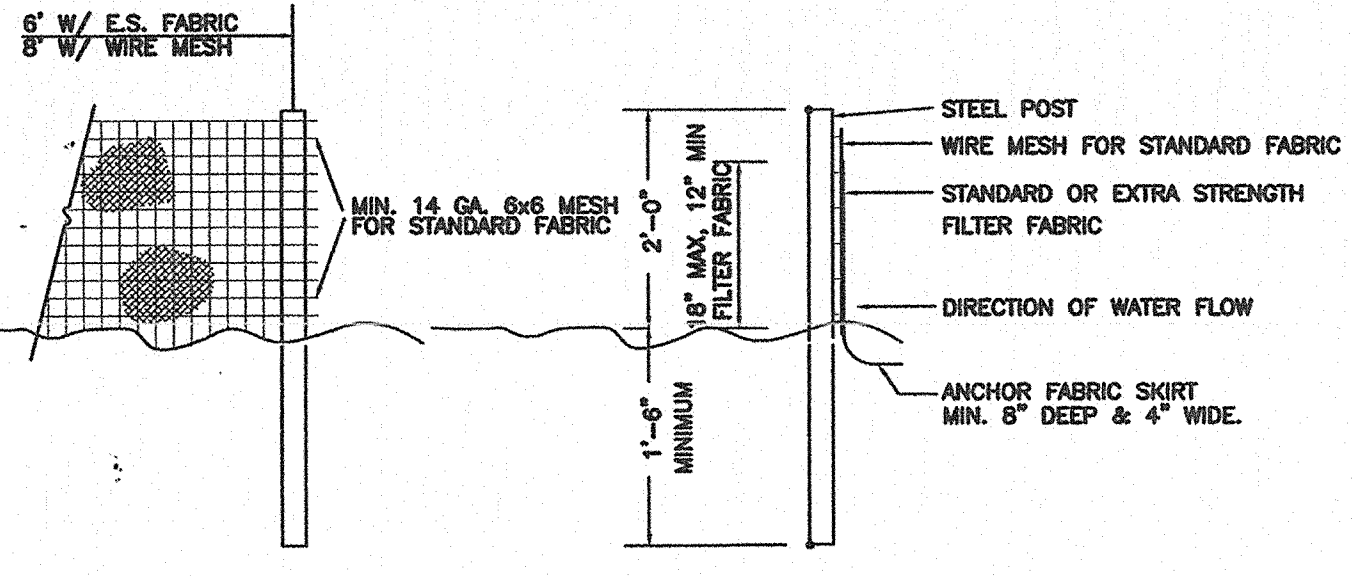

- NOTES:**
1. SYN. FENCE FABRIC SHALL BE MIN. OF 30" IN WIDTH WITH 30 LB/IN TENSILE STRENGTH FOR STANDARD FABRIC AND 50 LB/IN FOR EXTRA STRENGTH.
 2. FABRIC SHALL BE CONTINUOUS LENGTH. IF JOINTS ARE NECESSARY, LAP FABRIC POST TO POST.
 3. STEEL POST SHALL BE MIN. 4" IN HEIGHT AND BE OF THE SELF-FASTENER STEEL ANGLE TYPE.

2 TEMPORARY SILT FENCE

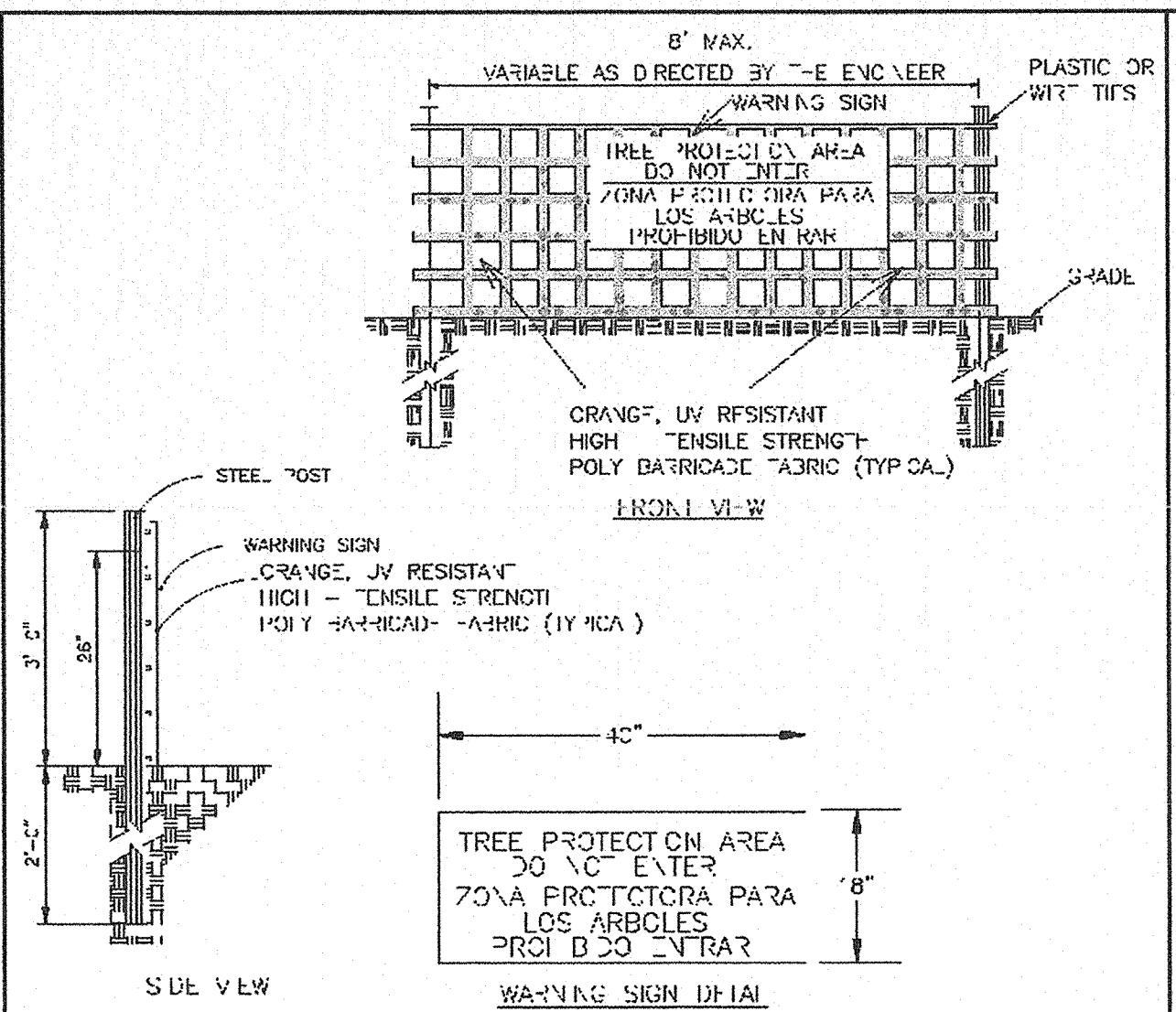

- NOTES:**
1. THE TREE PROTECTION FENCING SHALL NOT BE VIOLATED BY THE EXISTING DURATION OF THE PROJECT WITHOUT APPROVAL FROM URBAN FORESTRY STAFF.
 2. WARNING SIGNS TO BE MADE OF DURABLE, WEATHERPROOF MATERIAL. LETTERS TO BE 3" HIGH MINIMUM, CLEARLY LEGIBLE AND SPACED AS FOLLOWS.
 3. SIGNS SHALL BE PLACED AT 50' MAXIMUM INTERVALS. PLACE A SIGN AT EACH END OF LINEAR TREE PROTECTION AND 50' ON CENTER THEREAFTER. FOR TREE PROTECTION AREAS LESS THAN 100' IN PERIMETER, PROVIDE NO LESS THAN TWO SIGNS PER PROTECTION AREA.
 4. ATTACH SIGNS SECURELY TO FENCE POSTS AND FABRIC. MAINTAIN TREE PROTECTION HORIZONTAL AND VERTICAL. SIGNS SHOULD BE REMOVED AFTER CONSTRUCTION.
 5. TREE PROTECTION FENCING AND SIGNS SHALL BE REMOVED AFTER CONSTRUCTION.
 6. ADDITIONAL SIGNS MAY BE REQUIRED BY CITY OF WILMINGTON, BASED ON ACTUAL FIELD CONDITIONS.

3 TREE PROTECTION DETAIL

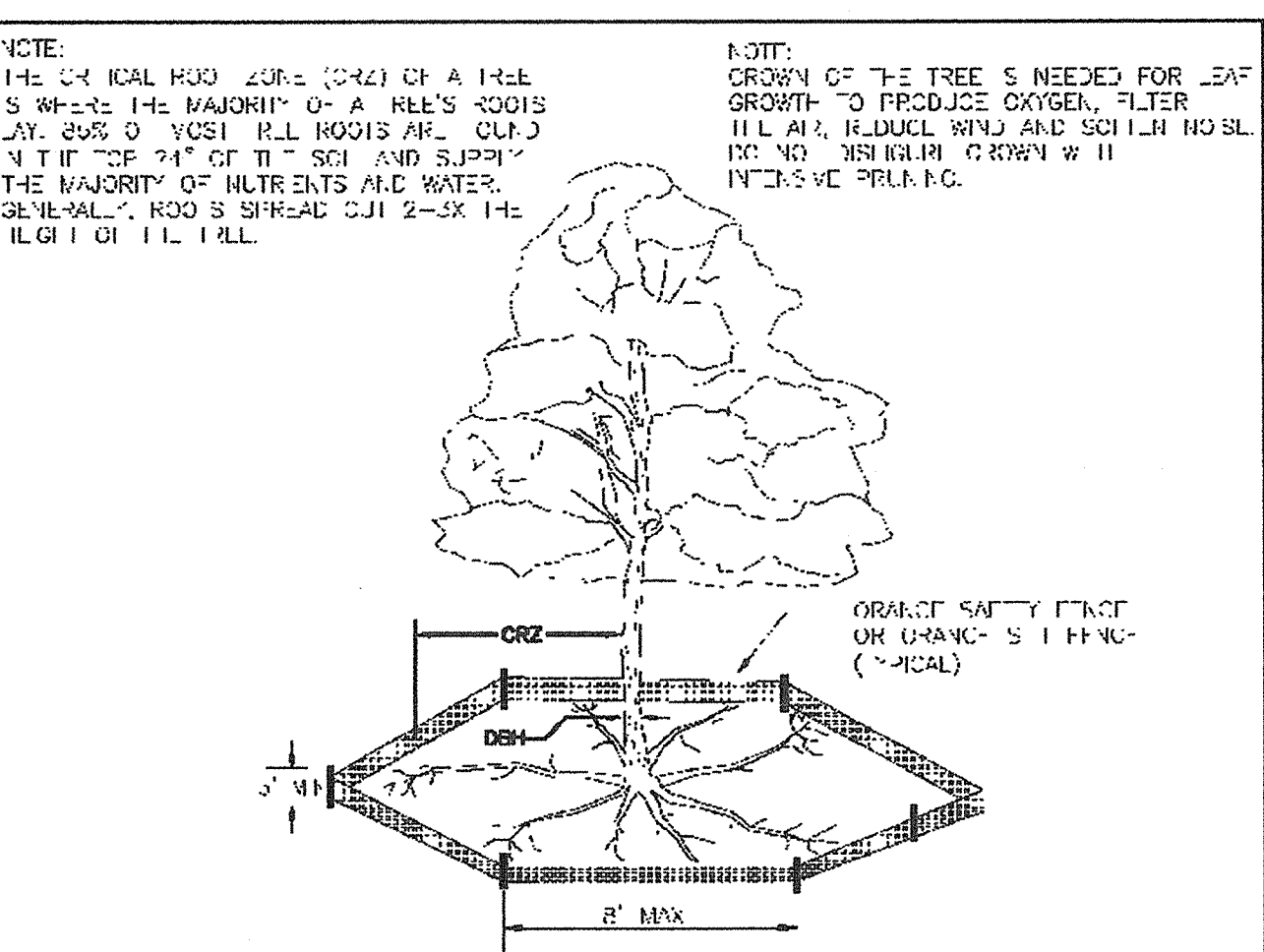

- NOTES:**
1. PROTECT ALL EXISTING AND NEW TREES FROM CONSTRUCTION CLEARLY MARKED BY THIS AND OTHER FIELD CONSTRUCTION STAFF.
 2. CRZ RADIUS IS 1 FT PER 1" TREE DIAMETER AT BREAST HEIGHT (DBH).
 3. IF CONSTRUCTION OCCURS WITHIN THE CRZ, AT LEAST 1" OF MULCH AND/OR JOSS MATS SHALL BE LAYED WHERE NECESSARY TO REDUCE SOIL COMPACTION IN THE ZONE.
 4. ALL MULCH, CLIPPING, AND SOIL SHALL BE REMOVED FROM THE CRZ IMMEDIATELY AFTER SEEDING AND ANCHOR MULCH. MULCH SHALL BE REPLACED AS NECESSARY.
 5. ALL MULCH SHALL BE REPLACED AS NECESSARY.
 6. ALL MULCH SHALL BE REPLACED AS NECESSARY.
 7. ALL MULCH SHALL BE REPLACED AS NECESSARY.
 8. ALL MULCH SHALL BE REPLACED AS NECESSARY.
 9. ALL MULCH SHALL BE REPLACED AS NECESSARY.
 10. ALL MULCH SHALL BE REPLACED AS NECESSARY.
 11. ALL MULCH SHALL BE REPLACED AS NECESSARY.

6 TREE PROTECTION DETAIL

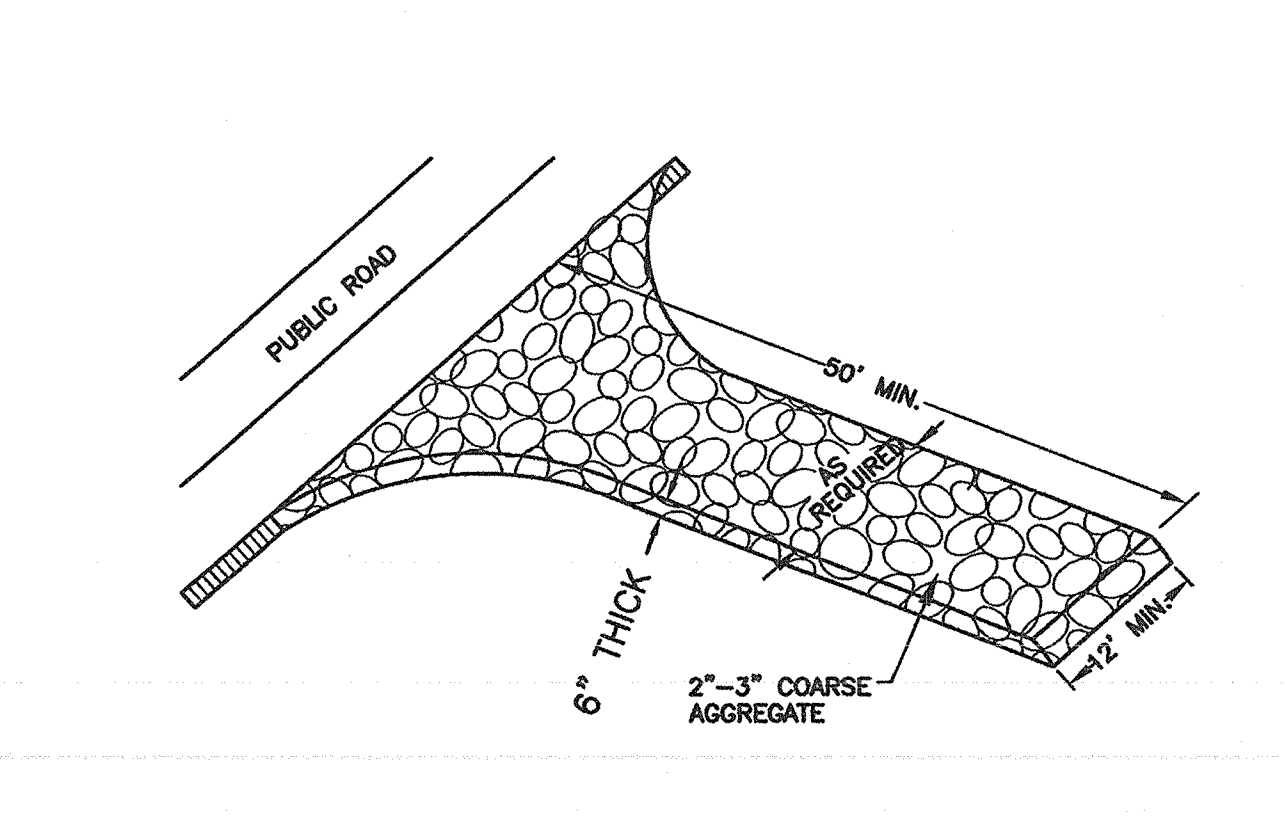

9 TEMPORARY GRAVELLED CONSTRUCTION ENTRANCE

EROSION CONTROL NOTES AND MAINTENANCE PLAN:

1. ALL EROSION AND SEDIMENT CONTROL MEASURES WILL BE CHECKED FOR STABILITY AND OPERATION FOLLOWING EVERY RAINFALL-PRODUCING RAINFALL, BUT IN NO CASE, LESS THAN ONCE EVERY WEEK AND WITHIN 24 HOURS OF EVERY HALF-INCH RAINFALL.
2. ALL POINTS OF EGRESS WILL HAVE CONSTRUCTION ENTRANCES THAT WILL BE PERIODICALLY TOP-DRESSED WITH AN ADDITIONAL 2 INCHES OF #4 STONE TO MAINTAIN PROPER DEPTH. THEY WILL BE MAINTAINED IN A MANNER TO PREVENT MUD OR SEDIMENT FROM LEAVING THE SITE. IMMEDIATELY REMOVE OBJECTIONABLE MATERIAL SPILLED WASHED OR TRACKED ONTO THE CONSTRUCTION ENTRANCE OR ROADWAYS.
3. SEDIMENT WILL BE REMOVED FROM HARDWARE CLOTH AND GRAVEL INLET PROTECTION, BLOCK AND GRAVEL INLET PROTECTION, ROCK DOUGHNUT INLET PROTECTION AND ROCK PIPE INLET PROTECTION WHEN THE DESIGNED STORAGE CAPACITY HAS BEEN HALF FILLED WITH SEDIMENT. ROCK WILL BE CLEANED OR REPLACED WHEN THE SEDIMENT POOL NO LONGER DRAINS AS DESIGNED. DEBRIS WILL BE REMOVED FROM THE ROCK AND HARDWARE CLOTH TO ALLOW PROPER DRAINAGE. SILT SACKS WILL BE EMPTIED ONCE A WEEK AND AFTER EVERY RAIN EVENT. SEDIMENT WILL BE REMOVED FROM AROUND WATLES, BEAVER DAMS, DANDY SACKS AND SOCKS ONCE A WEEK AND AFTER EVERY RAIN EVENT.
4. SEDIMENT WILL BE REMOVED FROM BEHIND THE SEDIMENT FENCE WHEN IT BECOMES HALF FILLED. THE SEDIMENT FENCE WILL BE REPAIRED AS NECESSARY TO MAINTAIN A BARRIER. STAKES MUST BE STEEL. STAKE SPACING WILL BE 6 FEET MAX. WITH THE USE OF EXTRA STRENGTH FABRIC, WITHOUT WIRE BACKING. STAKE SPACING WILL BE 8 FEET MAX. WHEN STANDARD STRENGTH FABRIC AND WIRE BACKING ARE USED. IF ROCK FILTERS ARE DESIGNED AT LOW POINTS IN THE SEDIMENT FENCE, THE ROCK WILL BE REPAIRED OR REPLACED IF IT BECOMES HALF-FULL OF SEDIMENT, NO LONGER DRAINS AS DESIGNED OR IS DAMAGED.
5. **LAND QUALITY REQUIRES:**
ALL SEEDED AREAS WILL BE FERTILIZED, RESEED AS NECESSARY, AND MULCHED, ACCORDING TO SPECIFICATIONS IN THE VEGETATIVE PLAN, TO MAINTAIN A VIGOROUS, DENSE VEGETATIVE COVER. ALL SLOPES WILL BE STABILIZED WITHIN 21 CALENDAR DAYS. ALL OTHER AREAS WILL BE STABILIZED WITHIN 15 WORKING DAYS.
WATER QUALITY REQUIRES:
ALL SEEDED AREAS WILL BE FERTILIZED, RESEED AS NECESSARY AND MULCHED ACCORDING TO SPECIFICATIONS IN THE VEGETATIVE PLAN TO MAINTAIN A VIGOROUS, DENSE VEGETATIVE COVER. ALL PERIMETER DIKES, SWALES, DITCHES, PERIMETER SLOPES, ALL SLOPES STEEPER THAN 3% HORIZONTAL TO 1% VERTICAL (3:1) AND ALL HIGH QUALITY WATER (HOW) ZONES SHALL BE PROVIDED TEMPORARY OR PERMANENT STABILIZATION WITH GROUND COVER AS SOON AS PRACTICABLE BUT IN ANY EVENT WITHIN SEVEN (7) CALENDAR DAYS FROM THE LAST LAND-DISTURBING ACTIVITY. ALL OTHER DISTURBED AREAS SHALL BE PROVIDED TEMPORARY OR PERMANENT STABILIZATION WITH GROUND COVER AS SOON AS PRACTICABLE BUT IN ANY EVENT WITHIN FOURTEEN (14) CALENDAR DAYS FROM THE LAST LAND-DISTURBING ACTIVITY.

SITE WORK NOTES:

1. THE CONTRACTOR SHALL VISIT THE SITE TO BECOME FAMILIAR WITH FIELD CONSTRUCTION CONDITIONS.
2. CONTRACTOR SHALL COORDINATE WORK WITHIN NCDOT AND LOCAL RIGHT OF WAY WITH PROPER AUTHORITIES AND SHALL MEET ANY REQUIREMENTS AS TO TRAFFIC CONTROL AND CONNECTION TO EXISTING STREETS.
3. CLEARING AND GRUBBING: SEE SPECIFICATIONS.
4. STRIPPING: SEE SPECIFICATIONS.
5. MUCKING: SEE SPECIFICATIONS.
6. BORROW MATERIAL: SEE SPECIFICATIONS.
7. FILL AND COMPACTION: SEE SPECIFICATIONS.
8. LAYOUT: THE CONTRACTOR SHALL PROVIDE ALL LAYOUT REQUIRED TO CONSTRUCT HIS WORK.
9. THE CONTRACTOR IS RESPONSIBLE FOR THE LOCATION AND PROTECTION OF EXISTING UTILITIES DURING CONSTRUCTION.
10. EXISTING BOUNDARY AND TOPOGRAPHIC INFORMATION FROM SURVEY BY BOB JONES, PLS AND PROVIDED BY OWNER.
11. THE CONTRACTOR SHALL VERIFY DIMENSIONS AT JOBSITE.
12. THE CONTRACTOR IS RESPONSIBLE FOR THE COORDINATION OF RELOCATION OR DISCONNECTION OF ALL EXISTING UTILITIES WITH APPLICABLE AGENCIES AND AUTHORITIES.
13. ALL PAVEMENT AND BASE MATERIALS AND WORKMANSHIP SHALL CONFORM TO NCDOT STANDARDS.
14. WATER AND SEWER SERVICES SHALL BE INSTALLED TO MEET LOCAL AND STATE PLUMBING CODES. METER AND TAPS SHALL MEET ALL LOCAL REQUIREMENTS.
15. ALL AREAS SHALL BE GRADED FOR POSITIVE DRAINAGE.
16. SEE SOILS REPORT FOR ADDITIONAL REQUIREMENTS.
17. CONTRACTOR SHALL NOTE THAT EARTHWORK QUANTITIES ARE HIS RESPONSIBILITY. PLANS DO NOT REPRESENT A BALANCED EARTHWORK CONDITION.

1 EROSION CONTROL INLET PROTECTION

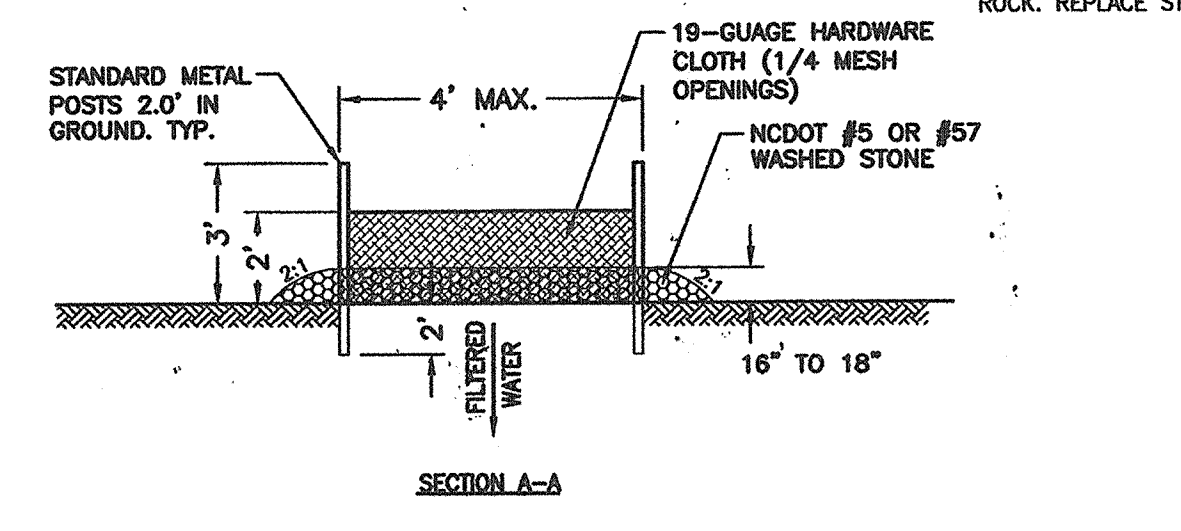
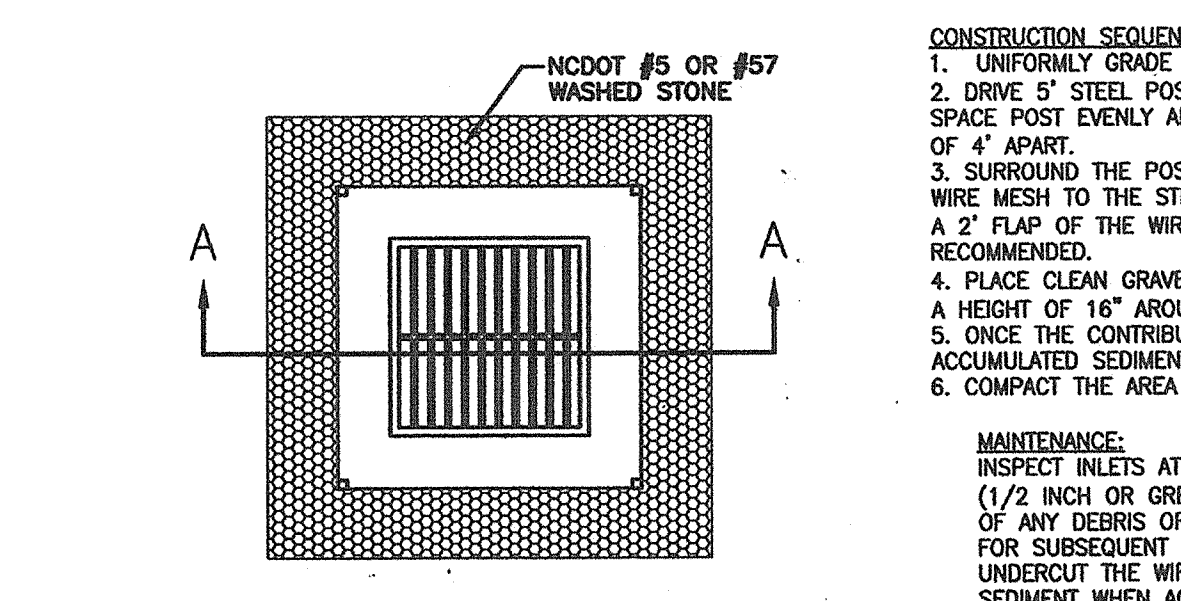

NOT TO SCALE

4 HARDWARE CLOTH AND GRAVEL INLET PROTECTION

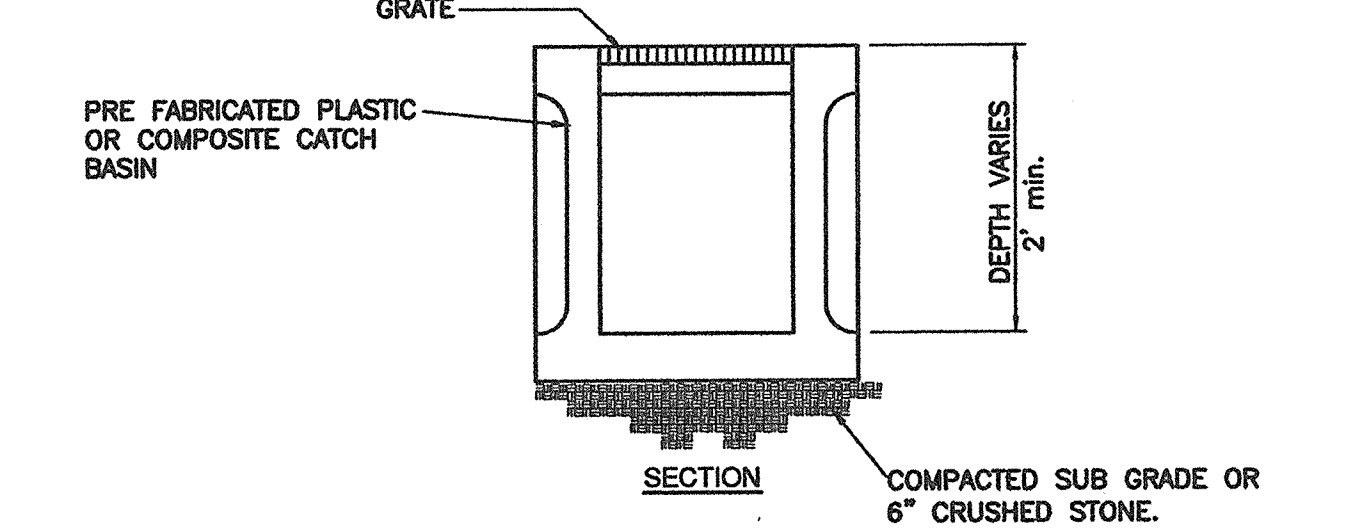
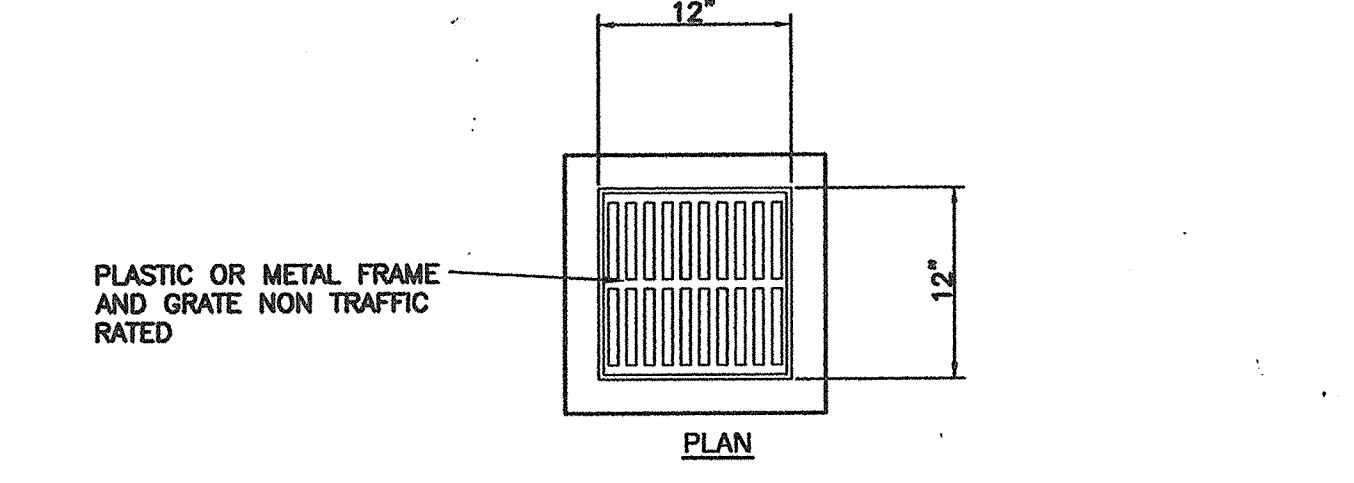

- NOTES:**
1. BASIN, FRAME AND GRATE MAY VARY IN NONESSENTIAL DIMENSIONS.
 2. ALL INFILTRATION PIPES OUT OF YARD INLETS SHALL BE PROTECTED WITH 1/4" ALUMINUM SCREEN WITH FILTER FABRIC ATTACHED TO BOX AT PIPE OPENING.

NOT TO SCALE

7 YARD INLET

8

TEMPORARY/PERMANENT GRASS SPECIFICATION:

1. CHISEL COMPACTED AREAS AND SPREAD TOPSOIL 3 INCHES DEEP OVER ADVERSE SOIL CONDITIONS.
 2. RIP THE ENTIRE AREA TO A 6 INCH DEPTH.
 3. REMOVE ALL ROCKS, ROOTS AND OTHER OBSTRUCTIONS LEAVING SURFACES SMOOTH AND UNIFORM.
 4. APPLY AGRICULTURAL LIME AND FERTILIZER UNIFORMLY AND MIX WITH SOIL.
LIME: 45 LBS. PER 1000 S.F.
PHOSPHOROUS: 20 LBS PER 1000 S.F.
FERTILIZER: 17 LBS. PER 1000 S.F.
 5. CONTINUE TILLAGE UNTIL A WELL PULVERIZED, FIRM, UNIFORM SEED BED IS PREPARED 4-6 INCHES DEEP.
 6. SEED ON A FRESHLY PREPARED SEED BED AND COVER SEED LIGHTLY.
2 - 3 LBS PER 1000 S.F. (SEE MIXTURE BELOW)
 7. MULCH IMMEDIATELY AFTER SEEDING AND ANCHOR MULCH.
GRAIN STRAW & HAY AT 75 TO 100 LBS PER 1000 S.F.
WOOD CHIPS AT 500 LBS. PER 1000 S.F.
JUTE & MESH AS PER MANUFACTURER
 8. ASPHALT FOR ANCHORING MULCH SHALL BE TYPE SS-1 EMULSION AND APPLIED AT A RATE OF 1000 GAL. PER ACRE FOR SLOPE STABILIZATION, AND 150 GAL. PER TON OF STRAW FOR ANCHORING STRAW.
 9. INSPECT ALL SEEDED AREAS AND MAKE NECESSARY REPAIRS OR RESEED WITHIN THE PLANTING SEASON, IF POSSIBLE. IF GRASS STAND SHOULD BE OVER 60% DAMAGED, REESTABLISH FOLLOWING ORIGINAL LIME, FERTILIZER AND SEEDING RATES.
 10. CONSULT CONSERVATION INSPECTOR ON MAINTENANCE, TREATMENT, AND FERTILIZATION AFTER PERMANENT COVER IS ESTABLISHED.
 11. SEED FOR TEMPORARY AND PERMANENT APPLICATIONS SHALL BE:
20% CARPET GRASS
28% BERMUDA GRASS
28% TURF FESCUE
10% CREEPING RED FESCUE
20% ANNUAL RYE GRASS
*BERMUDA SEED SHALL BE HULLED FOR WARM WEATHER PLANTING. PURITY OF SEED SHALL BE A MIN. OF 98% AND GERMINATION SHALL BE A MIN. OF 85%.
- ALL DISTURBED AREA SHALL BE SEEDED WITHIN 7-14 DAYS OF THE COMPLETION OF GRADING. SEE EROSION CONTROL AND MAINTENANCE NOTES. CONSULT CONSERVATION ENGINEER OR SOIL CONSERVATION SERVICE FOR ADDITIONAL INFORMATION CONCERNING OTHER ALTERNATIVES FOR VEGETATION OF DENUDEED AREAS. THE ABOVE VEGETATION RATES ARE THOSE WHICH DO WELL UNDER LOCAL CONDITIONS, OTHER SEEDING SCHEDULES MAY BE POSSIBLE.

CALL 811 (3) WORKING DAYS BEFORE YOU DIG.

For each open utility cut of City streets, a \$325 permit shall be required from the City prior to occupancy and/or project acceptance.

City of WILMINGTON
Public Services • Engineering Division
APPROVED STORMWATER MANAGEMENT PLAN
Date: 4/29/16 Permit # 2016016
Signed: [Signature]
Approved Construction Plan
Name: [Name] Date: 4/29/16
Planning: [Signature] 4-28-16
Traffic: [Signature] 4-28-16
Fire: [Signature] 5-4-16

NOTES AND DETAILS
ZIMMER CANCER CENTER RENOVATION
2131 SOUTH 17TH STREET
WILMINGTON, N. C.

OWNER/DEVELOPER
NHRMC
THOMAS WALSH, VP FACILITIES
AND SUPPORT SERVICES
PO BOX 9000
WILMINGTON, NC 28420
910-343-2768

NORRIS & TUNSTALL
CONSULTING ENGINEERS, P.C.
1429 ASH-LITTLE RIVER RD. NW
ASH, NC 28420
PHONE (910) 287-5900
license #C-3641

CONSTRUCTION DOCUMENTS
15120
DES. JST
DRWN. JPN
NKS
DATE 4/15/16

APPROVED STORMWATER MANAGEMENT PLAN
Date: 4/29/16 Permit # 2016016
Signed: [Signature]
Approved Construction Plan
Name: [Name] Date: 4/29/16
Planning: [Signature] 4-28-16
Traffic: [Signature] 4-28-16
Fire: [Signature] 5-4-16

C6

NOTE: INSTALLATION OF NEW 24" CURB AND GUTTER ALONG GLEN MEADE ROAD SHALL REQUIRE A 6" ABC STONE BASE.

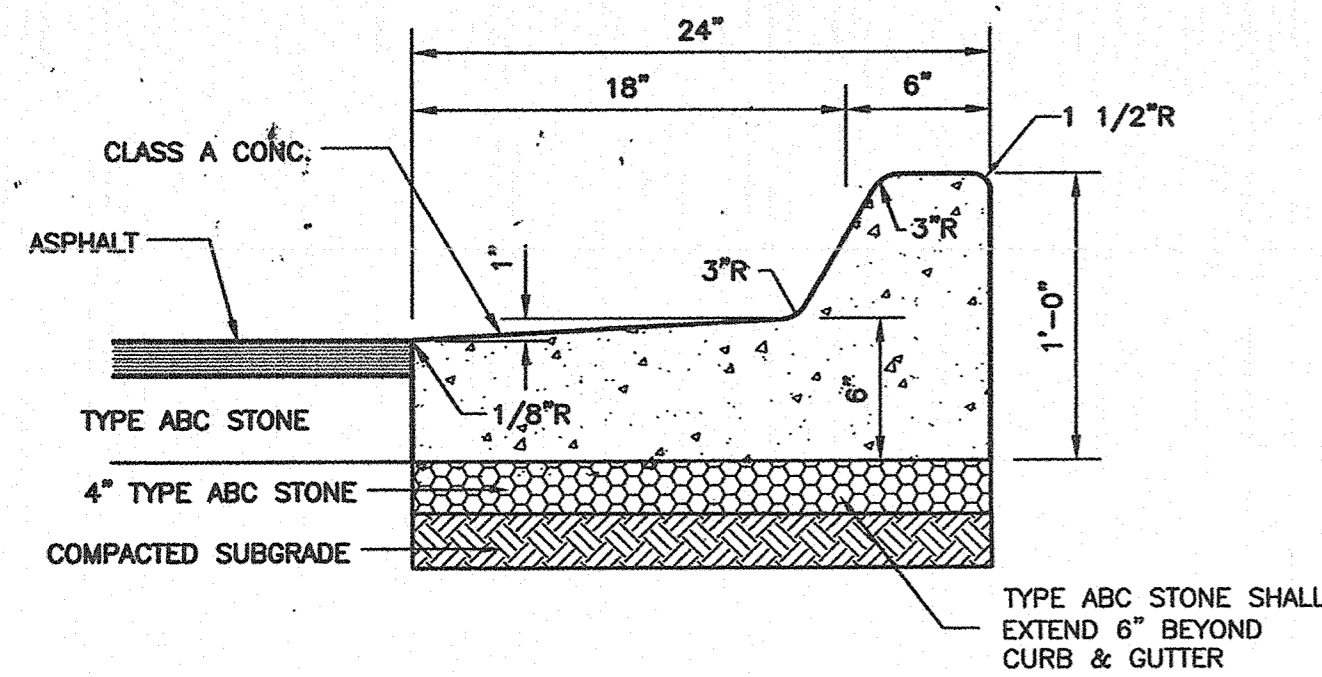

NOTE: CURB TYPE DEPENDS ON GRADES SHOWN ON GRADING PLAN. GRADES INDICATING FALL AWAY FROM CURB SHALL BE SPILL OFF TYPE CURB. GRADES INDICATING CURB ACCEPTING FLOW SHALL BE FLOW LINE TYPE.

NOT TO SCALE

NOTE: INSTALLATION OF NEW 24" CURB AND GUTTER ALONG GLEN MEADE ROAD SHALL REQUIRE A 6" ABC STONE BASE.

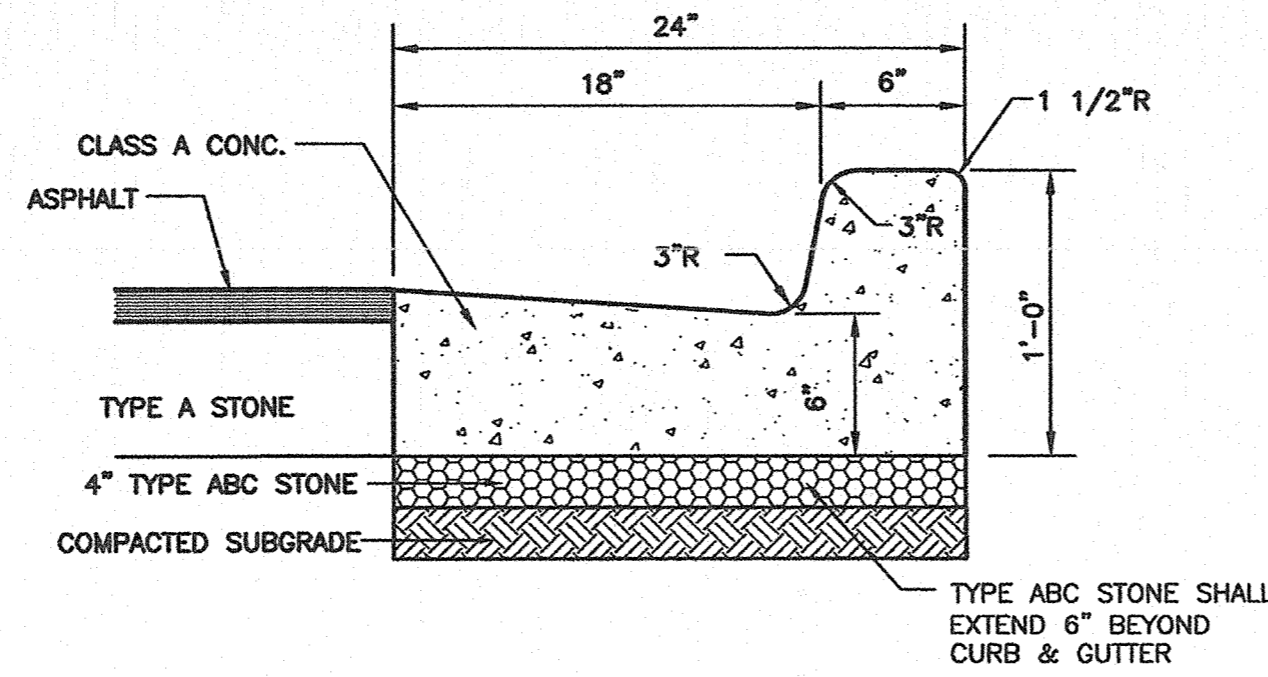

NOTE: CURB TYPE DEPENDS ON GRADES SHOWN ON GRADING PLAN. GRADES INDICATING FALL AWAY FROM CURB SHALL BE SPILL OFF TYPE CURB. GRADES INDICATING CURB ACCEPTING FLOW SHALL BE FLOW LINE TYPE.

NOT TO SCALE

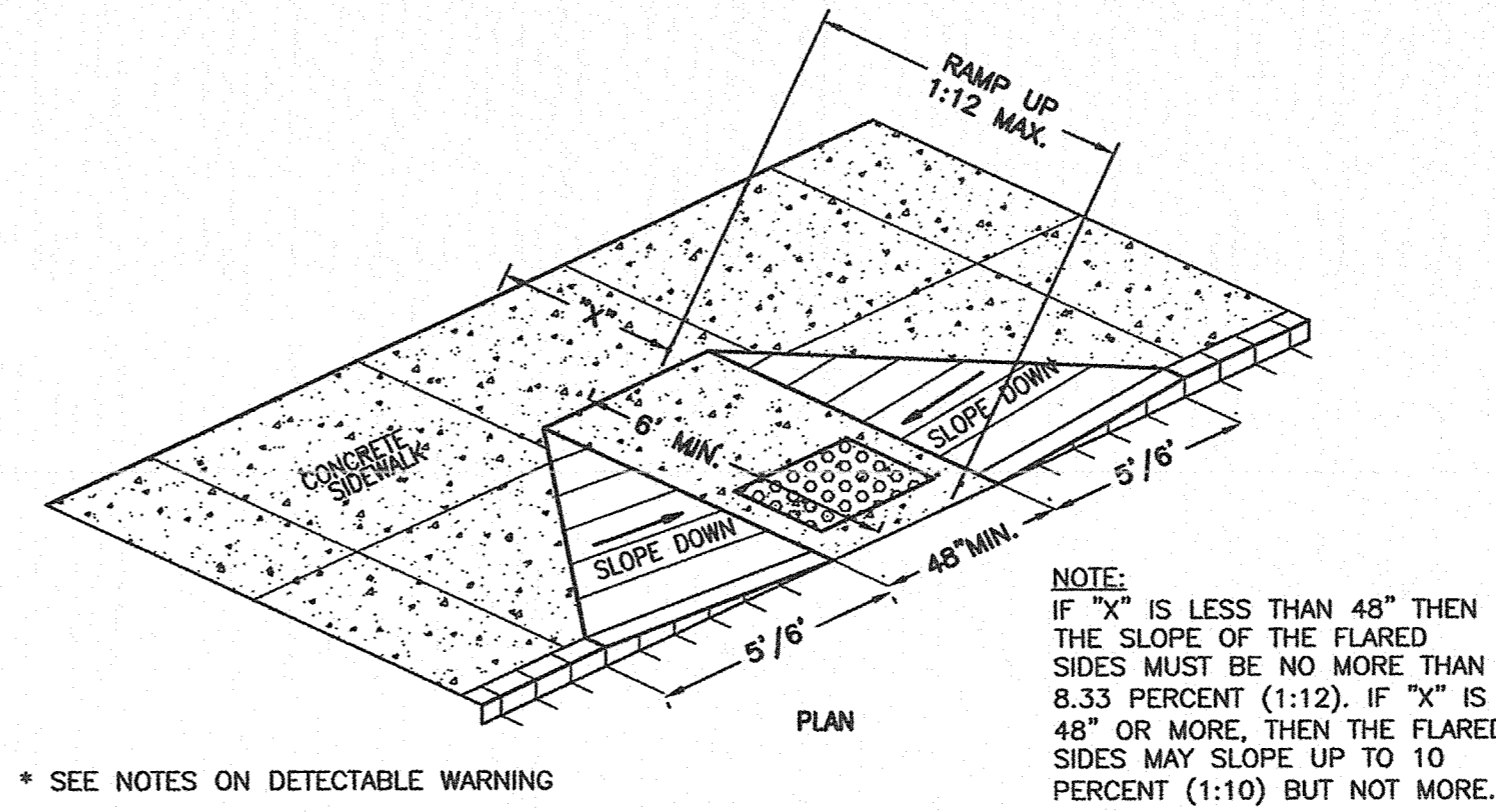

* SEE NOTES ON DETECTABLE WARNING

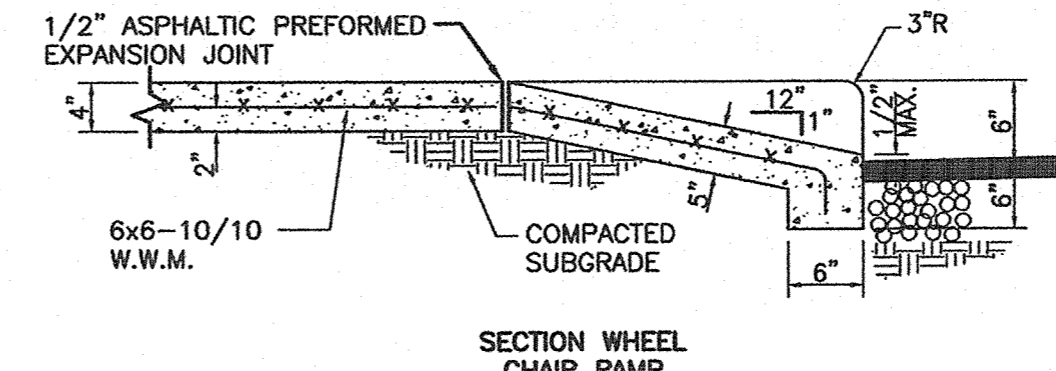

NOT TO SCALE

1 24" CURB AND GUTTER SECTION (SPILL-OFF)

2 24" CURB AND GUTTER SECTION (FLOW-LINE)

3 SIDEWALK, CURB CUT AND WHEEL CHAIR RAMP DETAIL

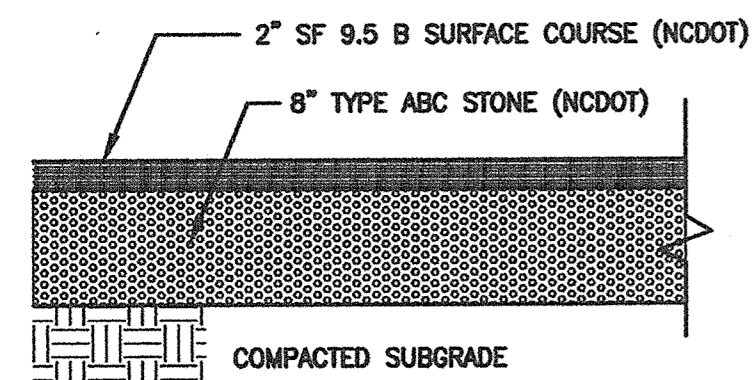

NOTE: PAVEMENT SECTION MAY VARY DEPENDING UPON FIELD CONDITIONS. CONTRACTOR SHALL COORDINATE w/OWNER & GEOTECHNICAL ENGINEER TO DETERMINE ACTUAL PAVEMENT SECTION.

NOT TO SCALE

4 ASPHALT PAVEMENT SECTION

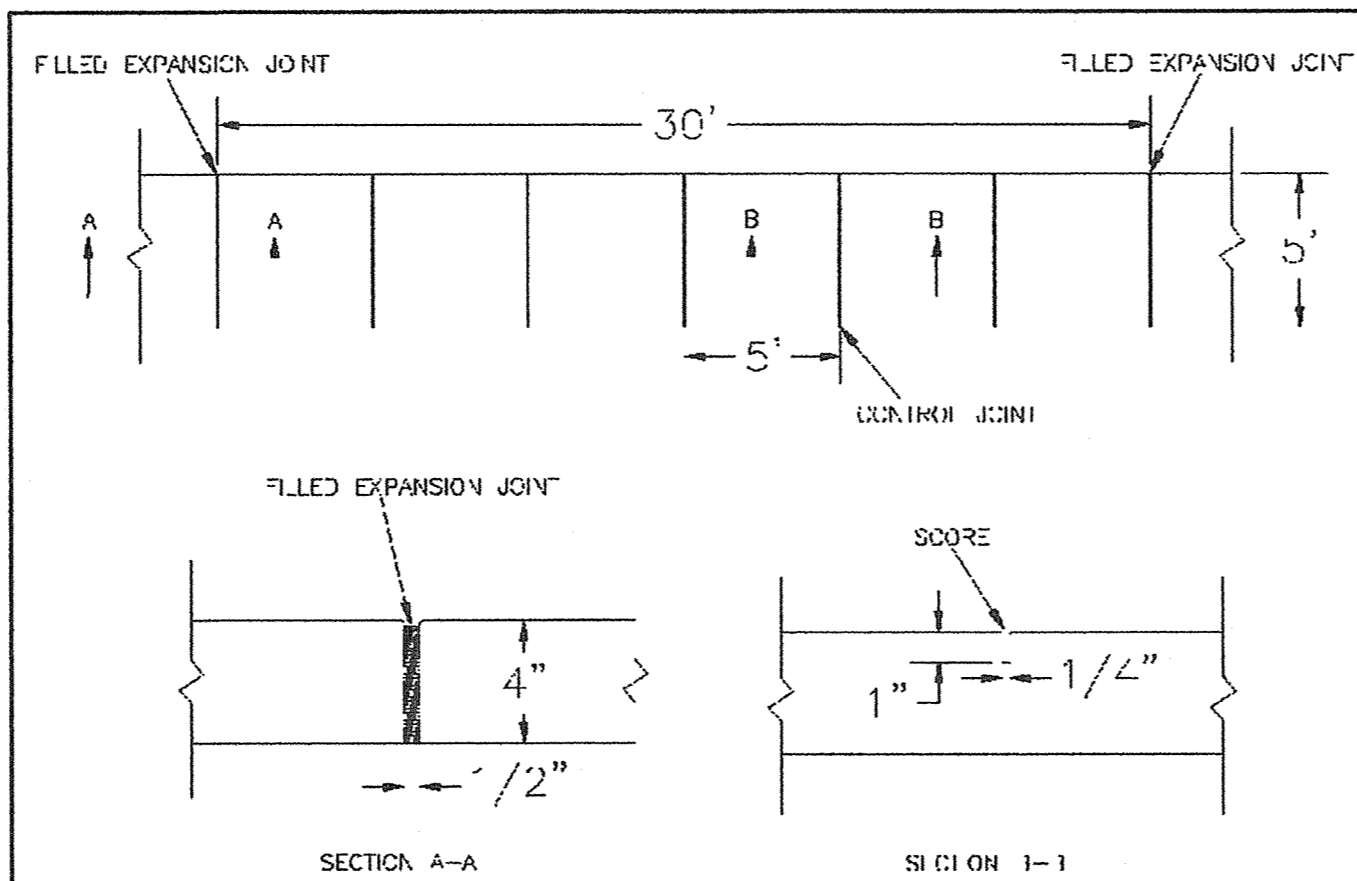

- NOTES:
1. JOINT MATERIAL TO COMPLY WITH CURRENT NCDOT STANDARDS.
 2. SANITARY SEWER CLEAN OUTS, WATER METERS, MANHOLES, AND VALVE LIDS TO BE LOCATED OUTSIDE SIDEWALK WHERE FEASIBLE.
 3. MINIMUM SIDEWALK WIDTH TO BE 6' MINIMUM IF PLACED AT BACK OF CURB.
 4. CONCRETE FOR ALL SIDEWALKS (EXCEPT ANY PORTION CONTAIN WITHIN A DRIVEWAY APRON) SHALL BE CLASS "A" - 3,000 PSI.
 5. MINIMUM REPLACEMENT FOR REPAIRS SHALL BE 5' X 5' PANEL.
 6. 4" STONE BASE MAY BE REQUIRED FOR POOR SOIL CONDITIONS.
 7. MINIMUM CURB HEIGHT WITHIN SIDEWALK IS 12"
 8. MAX ADJACENT GROUND SLOPE WITH CUT RAILING IS 2.0"
 9. MIN GRADE FOR FRONT DRAINAGE IS 1% IN AT LEAST 10' SECTION. MAX CROSS SLOPE IS 2%. MAX LONGITUDINAL SLOPE IS 8.33% 10% IF LIMITED BY EXISTING CONDITIONS, OR NO GREATER THAN 1% SLOPE TO THE EXISTING ADJACENT ROAD.

NOT TO SCALE

5 STANDARD SIDEWALK DETAIL

- NOTE:
1. RAMP SHALL HAVE A DETECTABLE WARNING COMPLYING WITH ADA GUIDELINES.
 2. THE DETECTABLE WARNINGS AT CURB RAMPS SHALL BE 24 INCHES MINIMUM IN THE DIRECTION OF TRAVEL AND EXTEND THE FULL WIDTH OF THE CURB RAMP OR FLUSH SURFACE.
 3. MARKED CROSSINGS THAT ARE RAISED TO THE SAME LEVEL AS THE ADJOINING SIDEWALK SHALL BE PRECEDED BY A 24 INCH DEEP DETECTABLE WARNING EXTENDING THE FULL WIDTH OF THE MARKED CROSSING.
 4. DETECTABLE WARNINGS SHALL CONSIST OF RAISED TRUNCATED DOMES WITH A DIAMETER OF NOMINAL 0.9 IN (23 MM), A HEIGHT OF NOMINAL 0.2 IN (5 MM) AND A CENTER-TO-CENTER SPACING OF NOMINAL 2.35 IN (60 MM) AND SHALL CONTRAST VISUALLY WITH ADJOINING SURFACES, EITHER LIGHT-ON-DARK, OR DARK-ON-LIGHT. THE MATERIAL USED TO PROVIDE CONTRAST SHOULD CONTRAST BY AT LEAST 70% - REFER TO ADA GUIDELINES FOR DEFINITION OF "CONTRAST".
 5. THE MATERIAL USED TO PROVIDE CONTRAST SHALL BE AN INTEGRAL PART OF THE WALKING SURFACE. DETECTABLE WARNINGS USED ON INTERIOR SURFACES SHALL DIFFER FROM ADJOINING WALKING SURFACES IN RESILIENCY OR SOUND-ON-CANE CONTACT.

NOT TO SCALE

6 NOTES ON DETECTABLE WARNING FOR WHEEL CHAIR RAMPS

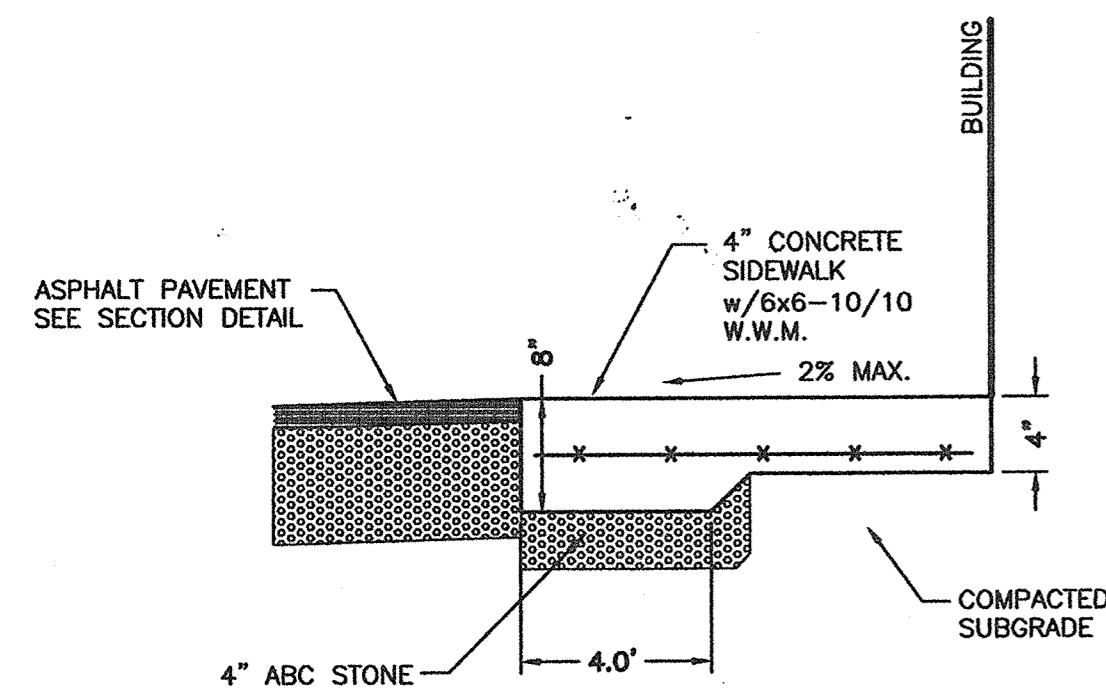

7 TURN DOWN WALK SECTION

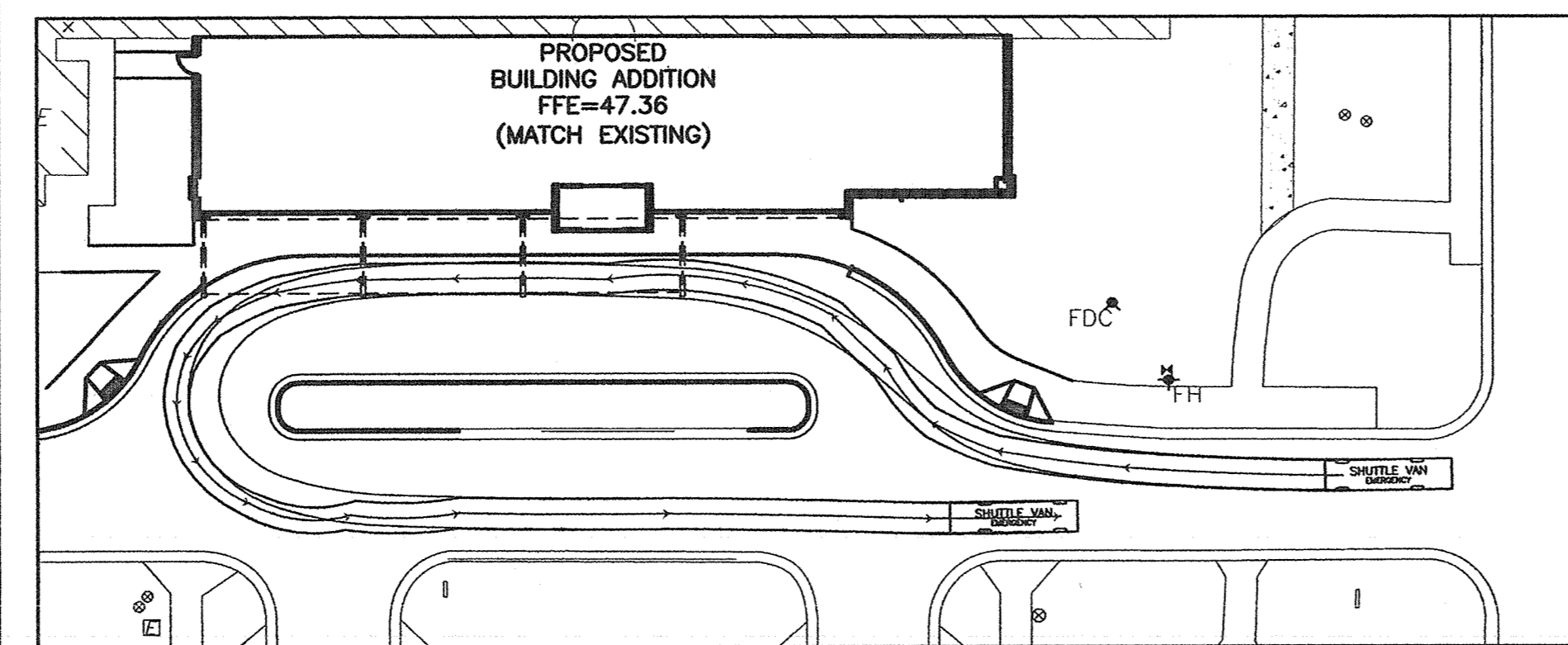

SCALE: 1"=30'

8 SHUTTLE VAN TURNING EXHIBIT

For each open utility cut of City streets, a \$325 permit shall be required from the City prior to occupancy and/or project acceptance.

CITY OF WILMINGTON
NORTH CAROLINA
Public Services • Engineering Division
APPROVED STORMWATER MANAGEMENT PLAN
Date: 4/29/16 Permit # 2016016
Signed: [Signature]

CITY OF WILMINGTON STANDARD NOTES:

1. CONTACT THE NORTH CAROLINA ONE CALL CENTER PRIOR TO DOING ANY DIGGING AT 1-800-632-4949.
2. PRIOR TO ANY CLEARING, GRADING OR CONSTRUCTION ACTIVITY, TREE PROTECTION FENCING WILL BE INSTALLED AROUND PROTECTED TREES OR GROVES OF TREES AND NO CONSTRUCTION WORKERS, TOOLS, MATERIALS, OR VEHICLES ARE PERMITTED WITHIN THE TREE PROTECTION FENCING.
3. ALL PAVEMENT MARKINGS IN PUBLIC RIGHTS-OF-WAY AND FOR DRIVEWAYS ARE TO BE THERMOPLASTIC AND MEET CITY AND/OR NCDOT STANDARDS.
4. ALL PARKING STALL MARKINGS AND LANE ARROWS WITHIN THE PARKING AREAS SHALL BE WHITE.
5. ALL TRAFFIC CONTROL SIGNS AND MARKINGS OFF THE RIGHT-OF-WAY ARE TO BE MAINTAINED BY THE PROPERTY OWNER IN ACCORDANCE WITH MUTCD STANDARDS.
6. TRAFFIC CONTROL DEVICES (INCLUDING SIGNS AND PAVEMENT MARKINGS) IN AREAS OPEN TO PUBLIC TRAFFIC ARE TO MEET MUTCD (MANUAL ON UNIFORM TRAFFIC CONTROL DEVICES) STANDARDS.
7. CONTACT TRAFFIC ENGINEERING AT 341-7888 FORTY-EIGHT HOURS PRIOR TO ANY EXCAVATION IN THE RIGHT-OF-WAY.
8. A UTILITY CUT PERMIT IS REQUIRED FOR EACH OPEN CUT OF A CITY STREET. CONTACT 341-5888 FOR MORE DETAILS. IN CERTAIN CASES AN ENTIRE RESURFACING OF THE AREA BEING OPEN CUT MAY BE REQUIRED.
9. ANY BROKEN OR MISSING SIDEWALK PANELS, DRIVEWAY PANELS, AND CURBING WILL BE REPLACED.
10. CONTACT TRAFFIC ENGINEERING AT 341-7888 TO DISCUSS STREET LIGHTING OPTIONS.
11. PROJECT SHALL COMPLY WITH CFPWA CROSS CONNECTION CONTROL REQUIREMENTS. WATER METER(S) CANNOT BE RELEASED UNTIL ALL REQUIREMENTS ARE MET AND THE STATE HAS GIVEN THEIR FINAL APPROVAL. CALL 343-3910 FOR INFORMATION.
12. IF THE CONTRACTOR DESIRES CFPWA WATER FOR CONSTRUCTION HE SHALL APPLY IN ADVANCE FOR THIS SERVICE AND MUST PROVIDE A REDUCED PRESSURE ZONE (RPZ) BACKFLOW PREVENTION DEVICE ON THE DEVELOPER'S SIDE OF THE WATER METER BOX.
13. ANY IRRIGATION SYSTEM SUPPLIED BY CFPWA WATER SHALL COMPLY WITH CFPWA CROSS CONNECTION CONTROL REGULATIONS. CALL 332-6558 FOR INFORMATION.
14. ANY BACKFLOW PREVENTION DEVICES REQUIRED BY CFPWA WILL NEED TO BE ON THE LIST OF APPROVED DEVICES BY USDFCCOHR OR ASSE.
15. WHEN PVC WATER MAINS AND/OR POLYETHYLENE SERVICES ARE PROPOSED, THE PIPES ARE TO BE MARKED WITH NO. 10 INSULATED SINGLE STRAND COPPER WIRE INSTALLED THE ENTIRE LENGTH AND SECURED TO ALL VALVES. THIS WIRE IS TO BE ACCESSIBLE AT ALL FIRE HYDRANTS AND WATER METER BOXES TO AID IN FUTURE LOCATION OF FACILITIES.
16. THE NUMBER AND SPACING OF DRIVEWAYS FOR ALL INTERCONNECTED SITES WILL BE DETERMINED BY THE COMBINED FRONTAGE OF THE INTERCONNECTED PROPERTIES.
17. UNDERGROUND FIRE LINE MUST BE PERMITTED AND INSPECTED BY THE WILMINGTON FIRE DEPARTMENT FROM THE PUBLIC ROW TO THE BUILDING. CONTACT THE WILMINGTON FIRE DEPARTMENT DIVISION OF FIRE AND LIFE SAFETY AT 910-343-0696 FOR ADDITIONAL INFORMATION.
18. A LANDSCAPE PLAN INDICATING THE LOCATION OF REQUIRED STREET TREES SHALL BE SUBMITTED TO THE CITY OF WILMINGTON TRAFFIC ENGINEER DIVISION AND PARKS AND RECREATION DEPARTMENT FOR REVIEW AND APPROVAL PRIOR TO THE RECORDING OF THE FINAL PLAT.
19. IF AN IRRIGATION SYSTEM IS PLANNED FOR THE SITE, UTILIZE MOISTURE SENSORS.
20. ALL PROPOSED VEGETATION WITHIN THE SIGHT TRIANGLES SHALL NOT INTERFERE WITH CLEAR VISUAL SIGHT LINES FROM 30'-10'.
21. PLEASE CONSIDER INCORPORATING XERIC LANDSCAPING FOR ALL NEW LANDSCAPING.

UTILITY NOTES FOR FIRE HYDRANTS:

1. FIRE HYDRANTS MUST BE WITHIN 150' OF THE FIRE DEPARTMENT CONNECTION.
2. THE FIRE DEPARTMENT CONNECTION MUST BE WITHIN 40' OF FIRE APPARATUS PLACEMENT.
3. LANDSCAPING AND PARKING CANNOT BLOCK OR IMPEDE THE FIRE DEPARTMENT CONNECTIONS OR FIRE HYDRANTS. A 3' CLEAR SPACE SHALL BE MAINTAINED AROUND THE CIRCUMFERENCE OF THE FIRE HYDRANT CONNECTION AND THE FIRE HYDRANT.
4. FIRE HYDRANTS MUST BE LOCATED WITHIN 8' OF THE CURB.
5. NEW HYDRANTS MUST BE AVAILABLE FOR USE PRIOR TO CONSTRUCTION OF THE BUILDINGS.
6. NEW HYDRANTS MUST BE BROUGHT INTO SERVICE PRIOR TO COMBUSTIBLE MATERIALS BEING DELIVERED TO THE JOB SITE.
7. THE CONTRACTOR SHALL MAINTAIN AN ALL WEATHER ACCESS FOR EMERGENCY VEHICLES AT ALL TIMES DURING CONSTRUCTION.
8. TEMPORARY STREET SIGNS SHALL BE INSTALLED AT EACH STREET INTERSECTION WHEN CONSTRUCTION OF NEW ROADWAYS ALLOWS PASSAGE BY VEHICLES.
9. UNDERGROUND FIRE LINE AND PRIVATE WATER MAINS MUST BE PERMITTED AND INSPECTED BY THE WILMINGTON FIRE DEPARTMENT FROM THE PUBLIC RIGHT-OF-WAY TO THE BUILDING. CONTACT THE WILMINGTON FIRE DEPARTMENT DIVISION OF FIRE AND LIFE SAFETY AT 910-343-0696 FOR ADDITIONAL INFORMATION.
10. A MINIMUM OF 5' SHALL SEPARATE UNDERGROUND FIRE LINES OR PRIVATE WATER MAINS FROM OTHER UNDERGROUND UTILITIES.
11. HYDRANTS SHALL BE OF SUFFICIENT NUMBERS TO ACCOMMODATE BASE FIRE FLOW REQUIREMENTS OF THE STRUCTURE.
12. BUILDING CONSTRUCTION TYPE: IIB

NOTES AND DETAILS
ZIMMER CANCER CENTER RENOVATION
2131 SOUTH 17TH STREET
WILMINGTON, N. C.

OWNER/DEVELOPER
NHRMC
THOMAS WALSH, VP FACILITIES
AND SUPPORT SERVICES
PO BOX 9000
WILMINGTON, NC 28402
910 343-2788

NORRIS & TUNSTALL
CONSULTING ENGINEERS, P.C.
1429 ASH-LITTLE RIVER RD., NW
ASH, NC 28420
PHONE (910) 343-9653
license #C-3641

CONSTRUCTION DOCUMENTS

15120

DES. JST
DRWL. JPN
NKS
DATE 4/15/16

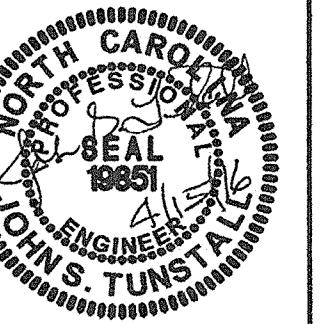

Approved Construction Plan
Name: [Signature] Date: 4/29/16
Planning: [Signature] 4/28/16
Traffic: [Signature] 4/28/16
Fire: [Signature] 5/4/16

SYMBOL	DATE	DESCRIPTION	BY
REVISIONS			
© 2016 NORRIS & TUNSTALL			

C7

ZIMMER CANCER CENTER MAIN ENTRANCE

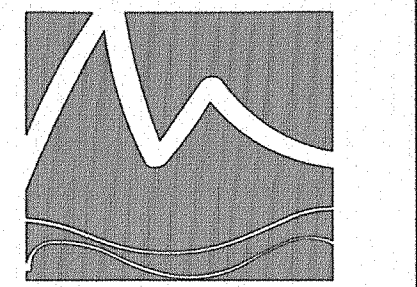
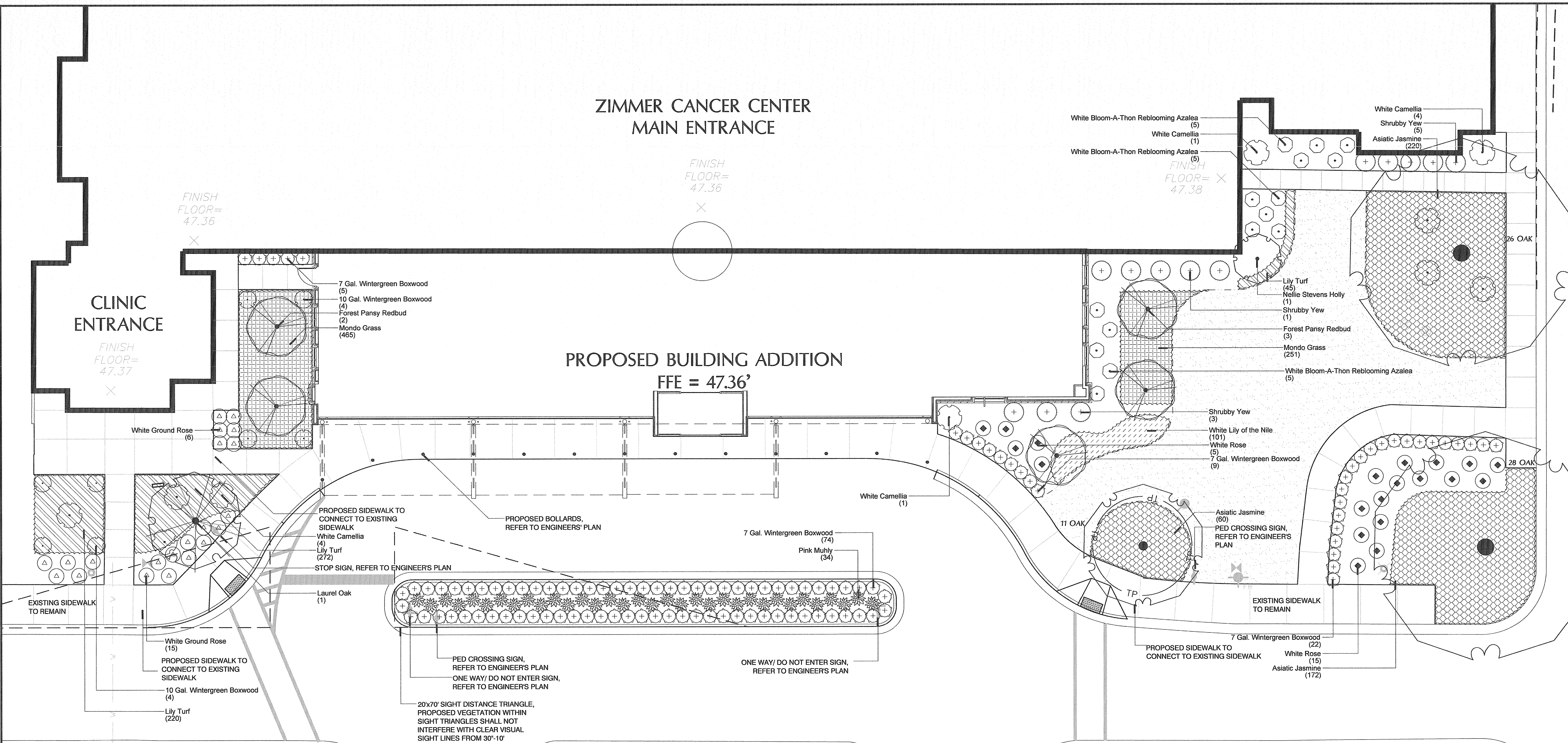

MIHALY
LAND DESIGN
PLANNING • LANDSCAPE ARCHITECTURE
330 Military Cutoff Rd. Suite A3
Wilmington, NC 28403 910.392.4355

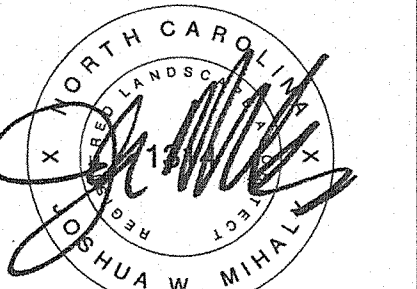

Revisions

- 1. 2016-04-28: ADDED SIGNATURE BLOCKS PER CITY REQUEST

CLIENT
ZIMMER CANCER CENTER RENO. LS3P ASSOCIATES LTD.
2825 INDEPENDENCE BLVD. SUITE 200
WILMINGTON, NC
PHONE: 910.790.9901

PROJECT

ZIMMER CANCER CENTER RENO. LS3P ASSOCIATES LTD.
2131 SOUTH 17TH STREET
WILMINGTON, NC
LANDSCAPE PLAN

CONSTRUCTION SET

Date: 04/19/2016
Phase: CD
Job Number: 560-05
Designed by: MLD
Drawn by: MAS
Checked by: JWM

Sheet Title: PLANTING PLAN
Sheet Number: **L1.1**
of 1 sheets

TREES	BOTANICAL NAME / COMMON NAME	CONT	CAL	RANGE	QTY
	Cercis c. 'Forest Pansy' TM / Forest Pansy Redbud	25 GAL	3" CAL	8-10' HT	5
	Ilex x 'Nellie R Stevens' / Nellie Stevens Holly	B & B		8-10' HT	1
	Quercus laurifolia / Laurel Oak	B&B	6" CAL	14-16' HT	1
SHRUBS	BOTANICAL NAME / COMMON NAME	SIZE	RANGE	QTY	
	Buxus m. 'Wintergreen' / 10 Gal. Wintergreen Boxwood	10 gal	24-36" HT	8	
	Buxus m. 'Wintergreen' / 7 Gal. Wintergreen Boxwood	7 gal	12-18" HT	112	
	Camellia sasanqua 'Hana Jiman' / White Camellia	25 gal	6" HT	10	
	Muhlenbergia capillaris / Pink Muhly	3 gal	18-24" HT	34	
	Podocarpus macrophyllus maki / Shrubby Yew	15 gal	5-6" HT	13	

GROUND COVERS	BOTANICAL NAME / COMMON NAME	SIZE	RANGE	SPACING	QTY
	Rhododendron x 'Bloom-a-thon' / White Bloom-A-Thon Reblooming Azalea	7 gal	24-30" HT		15
	Rosa x 'Flower Carpet White' / White Ground Rose	3 GAL	12-18" HT		21
	Rosa x 'Knockout' TM / White Rose	7 gal	24-30" HT		20
SOD/SEED	BOTANICAL NAME / COMMON NAME	SIZE	RANGE	SPACING	QTY
	Agapanthus africanus 'White' / White Lily of the Nile	1 GAL	12-15" HT	14" o.c.	101
	Lilium muscarif / Lily Turf	1 qt	12-15" HT	12" o.c.	537
	Ophiopogon japonicus / Mondo Grass	1 qt	12-15" HT	12" o.c.	716
	Trachelospermum a. 'Asiatic' / Asiatic Jasmine	1 qt	6-12" HT	24" o.c.	452
	Sod / Sod ' Match Existing Species'	sod			2,761 sf

LANDSCAPE REQUIREMENTS

ADDRESS: 2131 SOUTH 17TH STREET
PARCEL ID: R06011-004-001-000
TOTAL PROJECT AREA: 1.54 ACRES
EXISTING ZONING: O&I - OFFICE AND INSTITUTIONAL
CAMA LAND CLASSIFICATION: URBAN
USE: HOSPITAL CANCER TREATMENT (NHRMC)

LANDSCAPE REQUIREMENTS	REQUIRED	PROVIDED
FOUNDATION PLANTINGS (240 LF ² x 33") x .12	950 SF	3,461 SF
15 TREES PER ACRE DISTURBED (0.37 AC x 15)	6	9 (3 EXISTING) (6 PROPOSED)

LEGEND

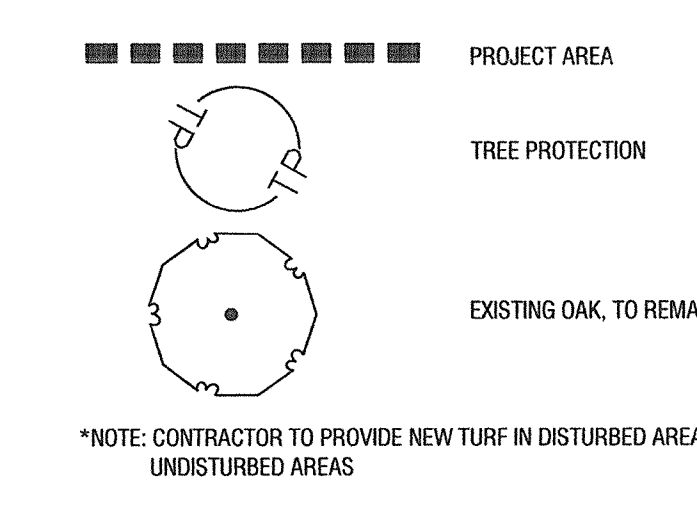

*NOTE: CONTRACTOR TO PROVIDE NEW TURF IN DISTURBED AREAS UP TO EXISTING UNDISTURBED AREAS

Approved Construction Plan
Name: [Signature] Date: 4/28/16
Planning: [Signature] Date: 4/28/16
Public Utilities: [Signature] Date: 4/28/16
Traffic: [Signature] Date: 4/28/16
Fire: [Signature] Date: 5/4/16

CITY OF WILMINGTON
NORTH CAROLINA
Public Services/Engineering Division
APPROVED DRAINAGE PLAN
Date: 4/28/16 Permit # 2016016
Signed: [Signature]

GENERAL PLANTING NOTES

- THIS WORK INCLUDES, BUT IS NOT LIMITED TO THE FURNISHING OF ALL LABOR, MATERIALS, EQUIPMENT, FINAL GRADING, SEEDING, SOIL AMENDMENTS, ETC., AS MAY BE REQUIRED FOR A COMPLETE INSTALLATION.
- QUANTITIES SHOWN IN PLANT LISTS ARE FOR CONVENIENCE ONLY. PLANS SHALL GOVERN.
- THE LANDSCAPE CONTRACTOR SHALL NOTIFY THE LANDSCAPE ARCHITECT OF ANY DISCREPANCIES IN PLANT LOCATIONS OR INSUFFICIENT PLANT QUANTITIES DUE TO DIFFERENCES IN PLAN AND ACTUAL FIELD CONDITIONS.
- ALL TREE AND SHRUB MATERIAL SPECIFIED MUST MEET STANDARD INDUSTRY SPECIFICATIONS FOR THE CONTAINER SIZE INDICATED. DOWNSIZING OR SUBSTITUTION OF PLANT MATERIAL WITHOUT PRIOR APPROVAL OF LANDSCAPE ARCHITECT WILL NOT BE ALLOWED.
- ALL LANDSCAPE AREAS SHALL BE GRADED TO A SMOOTH EVEN SURFACE PRIOR TO ANY PLANT INSTALLATION. ALL PLANT MATERIALS SHALL BE INSTALLED USING GOOD HORTICULTURAL PRACTICES IN ACCORDANCE WITH THE PLANS AND DETAILS.
- TREES SHALL NOT BE PLANTED CLOSER THAN FOUR (4) FEET FROM ANY WALKWAY OR PUBLIC SIDEWALK EXCEPT WHERE TREE WELLS OR PARKWAYS ARE PROVIDED IN THE SIDEWALK AREA. ALL TREE PLANTED WITHIN FIVE (5) FEET OF WALKS OR PUBLIC UTILITIES SHALL RECEIVE DEEP ROOT BARRIERS.
- TREE LOCATIONS SHOWN ON PLAN MAY REQUIRE ADJUSTMENT IN THE FIELD. WHENEVER FEASIBLE, TREES SHOULD BE PLANTED A MINIMUM OF TEN (10) FEET FROM ALL UNDERGROUND UTILITIES, STREETLIGHTS, HYDRANTS, AND OUT OF DRAINAGE FLOW LINES. SHOULD THIS NOT BE POSSIBLE, CONTACT THE LANDSCAPE ARCHITECT FOR DECISION ON PLACEMENT.
- ALL TREES IN TURF AREAS SHALL HAVE 12" MIN. CLR. CIRCUMFERENCE AROUND THE TRUNK BASE. PROVIDE 2" MIN. THK. MULCH AT BASE OF TRUNK.
- GROUND COVER TYPE SHOWN SHALL BE PLANTED IN ALL SHRUB AREAS AS SPECIFIED ON PLANS. GROUND COVER SHALL BE PLANTED AT 8" ON-CENTER UNIFORM TRIANGULAR SPACING, AND SHALL BE CONTINUOUS UNDER ALL TREE AND SHRUB MASSES AS SHOWN ON PLAN.
- MATURE PLANTINGS SHALL NOT INTERFERE WITH UTILITIES AND TRAFFIC SIGHT LINES.
- ALL PLANTING AREAS SHALL BE MULCHED WITH PINE STRAW, EXCEPT FOR AREAS PLANTED WITH GROUND COVER. ALL AREAS PLANTED WITH GROUND COVER SHALL BE MULCHED WITH HARDWOOD MULCH.

